



Western Products
PO Box 245038
Milwaukee, WI 53224-9538
www.westernplows.com



A DIVISION OF DOUGLAS DYNAMICS, LLC

**29351 – PRO PLUS®, WIDE-OUT™
& WIDE-OUT™ XL Blades
64183 – PRO-PLOW® Series 2
Blades
BACK DRAG EDGE BOLT KITS
Installation Instructions**

⚠ WARNING

Do not exceed GVWR or GAWR, including blade and ballast. The rating label is found on the driver-side vehicle door cornerpost.

⚠ WARNING

Blade can drop unexpectedly. Place quadrant on jack stands. Failure to do so could result in serious personal injury.

⚠ CAUTION

Read this document before installing the Back Drag Edge.

⚠ CAUTION

Use standard methods and practices when attaching snowplow and installing accessories, including proper personal protective safety equipment.

⚠ CAUTION

See your WESTERN® outlet/website for specific vehicle application recommendations before installation. The Quick Match selection system has specific vehicle and snowplow requirements.

INSTALLATION INSTRUCTIONS

1. Park the vehicle on a smooth, level, hard surface, such as concrete. Raise the blade, then turn the control OFF. From the side of the blade assembly, place jack stands under the quadrant.
2. Turn the control ON and lower the blade so the blade rests securely on the jack stands. Turn the control OFF. Turn the vehicle ignition to the "OFF" position and remove the key.
3. Remove and discard the original carriage bolts and locknuts that secure the cutting edge to the blade.

WIDE-OUT and WIDE-OUT XL blades only:
Remove and discard the original carriage bolts and locknuts that secure the driver- and passenger-side wing cutting edges to the wings.
4. Position the back drag edge between the cutting edge and blade as shown below. Secure both the cutting edge and back drag edge to the blade with the carriage bolts and locknuts from the bolt kit. If supplied in the bolt kit, place washers on carriage bolts between the locknuts and blade (29351 PRO PLUS, WIDE-OUT, and WIDE-OUT XL kits only).

**PRO-PLOW Series 2 Blades: 1/2" Fasteners
PRO PLUS, WIDE-OUT, and
WIDE-OUT XL Blades: 5/8" Fasteners**

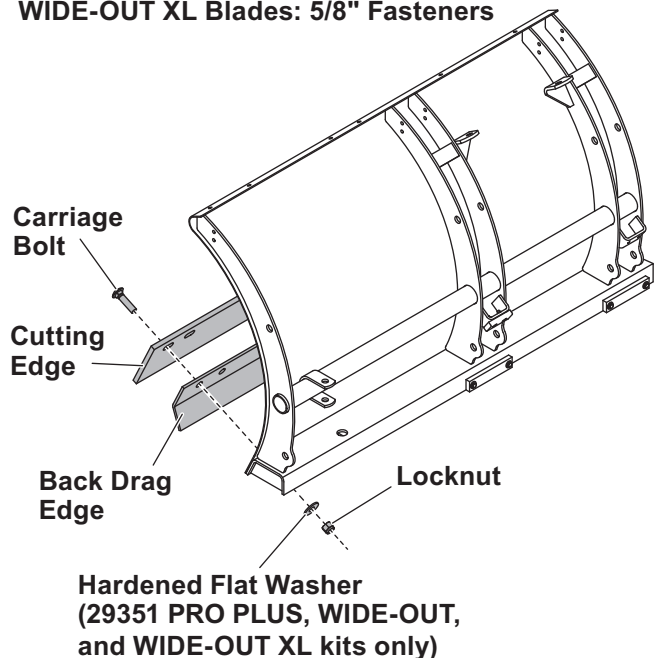

29351 & 64183 BACK DRAG EDGE BOLT KITS

WIDE-OUT™ and WIDE-OUT™ XL blades only:

Insert the supplied backer bar between the wing cutting edge and the wing as shown below.

Secure the wing edge and backer bar to the wing with the supplied 1/2" carriage bolts and 1/2" locknuts. Repeat on other side.

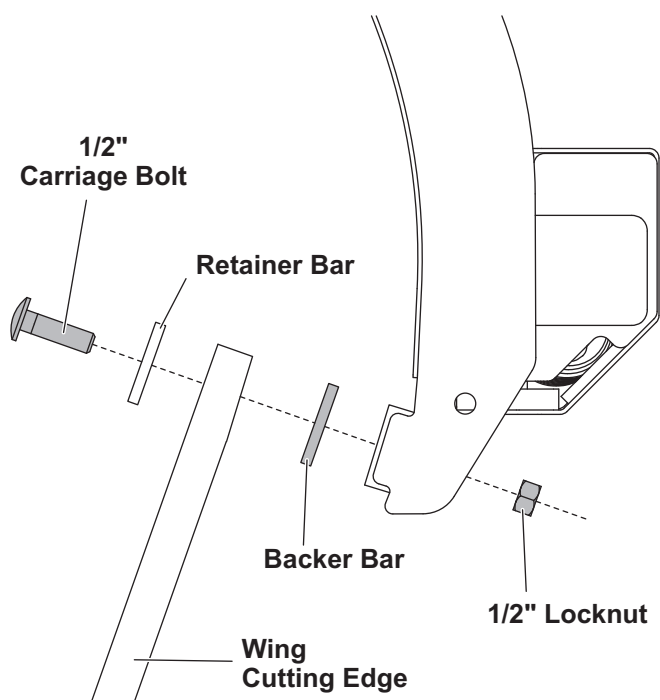

NOTE: The illustration represents typical components. The shape of the cutting edge may vary from the one shown above.

5. **64183 PRO-PLOW® Series 2, and WIDE-OUT and WIDE-OUT XL wing kits:** Torque fasteners to 115 ft-lb.

29351 PRO PLUS®, and WIDE-OUT and WIDE-OUT XL main cutting edge kits: Torque fasteners to 150 ft-lb.

6. Turn the vehicle ignition and the snowplow control ON. Raise the blade slightly from the jack stands. Turn the control OFF and remove the jack stands.
7. Standing 8 feet clear of the blade, lower the blade to the ground. Turn the control OFF.

Western Products reserves the right under its product improvement policy to change construction or design details and furnish equipment when so altered without reference to illustrations or specifications used. Western Products or the vehicle manufacturer may require or recommend optional equipment for snow removal. Do not exceed vehicle ratings with a snowplow. Western Products offers a limited warranty for all snowplows and accessories. See separately printed page for this important information. The following are registered (®) or unregistered (™) trademarks of Douglas Dynamics, LLC: PRO-PLOW® Series 2, PRO PLUS®, UltraMount® 2, WESTERN®, WIDE-OUT™, WIDE-OUT™ XL.

Printed in U.S.A.