

April 5, 1998
Doc. No. 68587

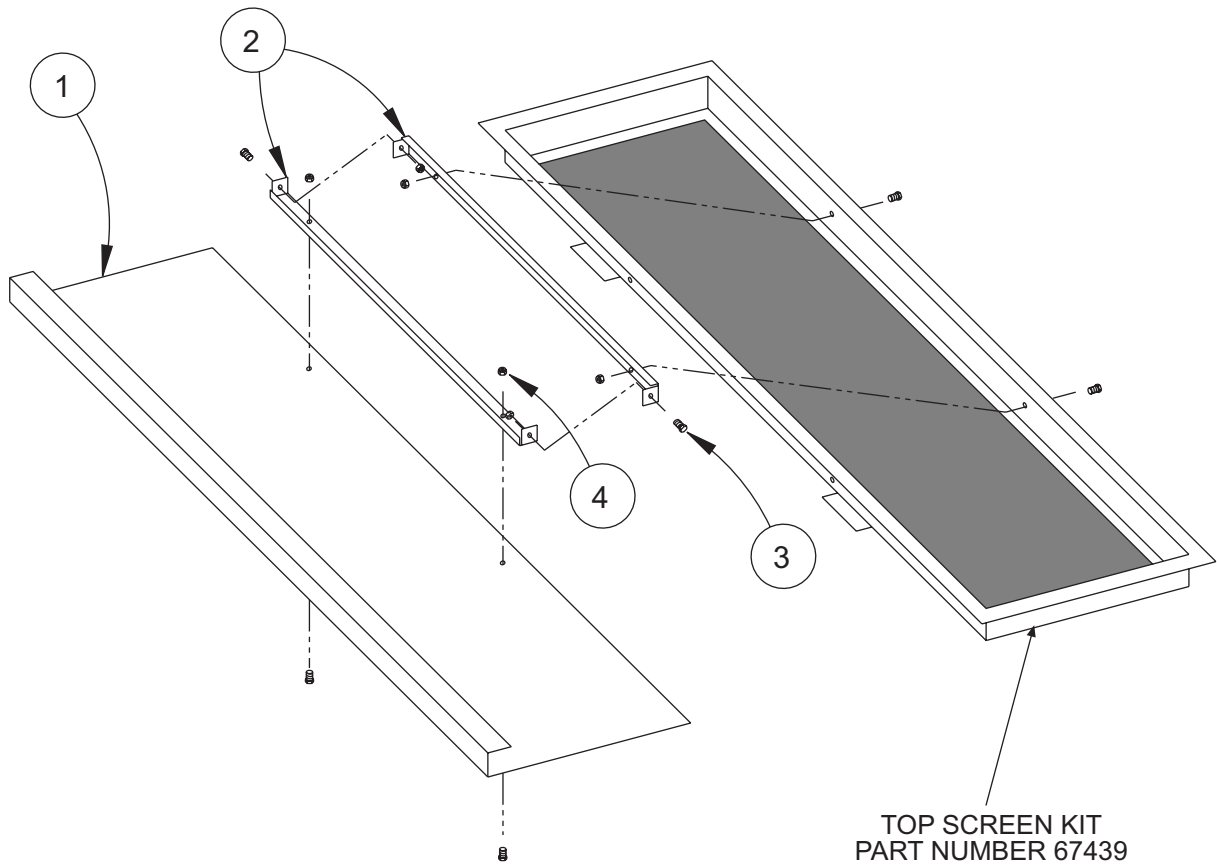

Back Stop Assembly – 67442			
Ref #	Part #	Qty	Description
1	P2079	1	Screen Lid
2	P2078	2	Screen Lid Hinge
3	90615	6	1/4-20 x 1/2" SHCS
4	91331	6	1/4-20 Locknut

1. Attach one of the hinge halves to the lid using two 1/4-20 x 1/2" bolts and locknuts. Position the hinge half as illustrated above.
2. Attach the second hinge half to the one on the lid using two 1/4-20 x 1/2" bolts and locknuts through the end flanges. Do not fully tighten.
3. Attach the assembled lid and hinge to the screen with two 1/4-20 x 1/2" bolts and locknuts.

The company reserves the right under its product improvement policy to change construction or design details and furnish equipment when so altered without reference to illustrations or specifications used herein.