



A DIVISION OF DOUGLAS DYNAMICS, LLC

Western Products
PO Box 245038
Milwaukee, WI 53224-9538
www.westernplows.com

79445 – ENFORCER™ Blade

Adjustment Plate Kit

Parts List & Installation Instructions

PARTS LIST

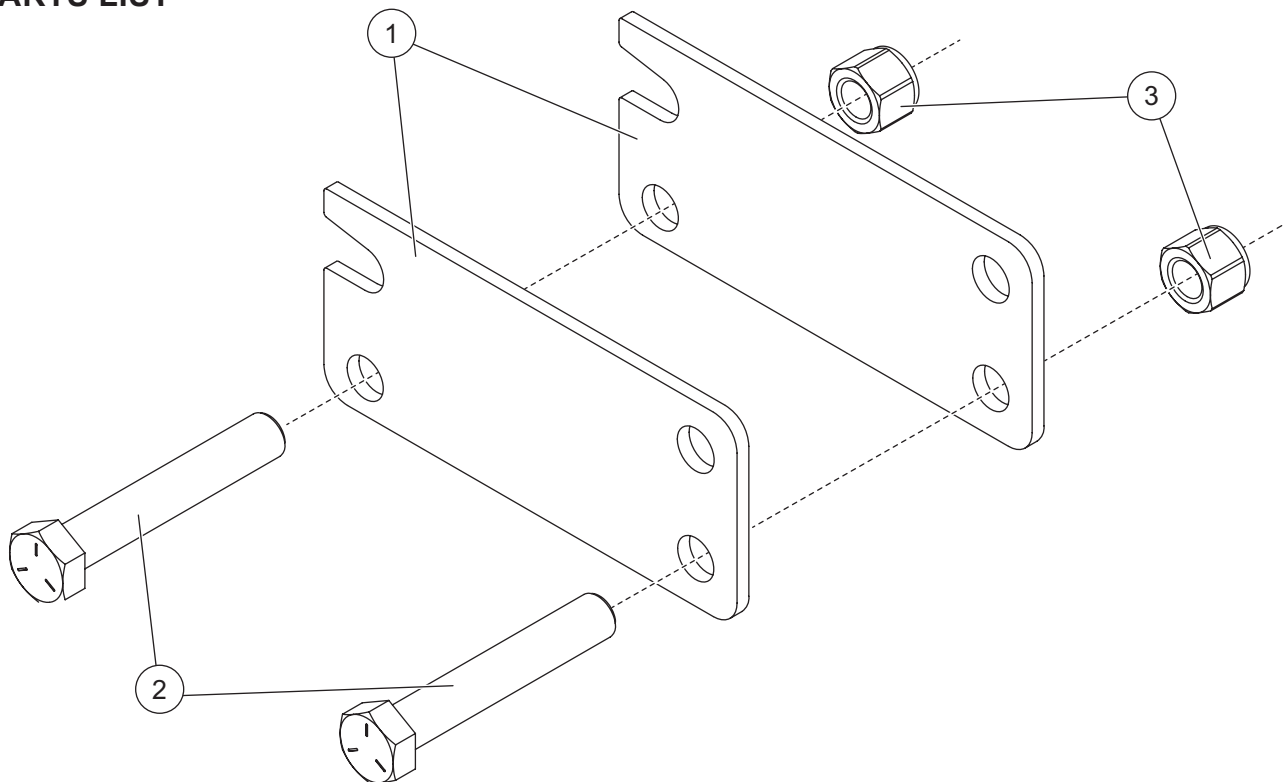

79445 Adjustment Plate Kit							
Item	Part	Qty	Description	Item	Part	Qty	Description
1	69522	4	Height Adjustment Plate	3		4	3/4-10 Hex Locknut GB
2		4	3/4-10 x 4-1/2 Hex Cap Screw G5				
G = Grade							

⚠ WARNING

Do not exceed GVWR or GAWR, including blade and ballast. The rating label is found on the driver-side vehicle door cornerpost.

⚠ WARNING

Blade can drop unexpectedly. Place blade on jack stands. Failure to do so could result in serious personal injury.

⚠ CAUTION

Read this document before installing the adjustment plate kit.

⚠ CAUTION

Use standard methods and practices when attaching snowplow and installing accessories, including proper personal protective safety equipment.

⚠ CAUTION

See your WESTERN® outlet/website for specific vehicle application recommendations before installation. The Quick Match selection system has specific vehicle and snowplow requirements.

79445 ENFORCER™ ADJUSTMENT PLATE KIT

INSTALLATION INSTRUCTIONS

1. Park the vehicle on a smooth, level, hard surface, such as concrete.
2. Measure the distance "d" from the ground to the top edge of the receiver bracket. Measure both sides and determine average value for "d."

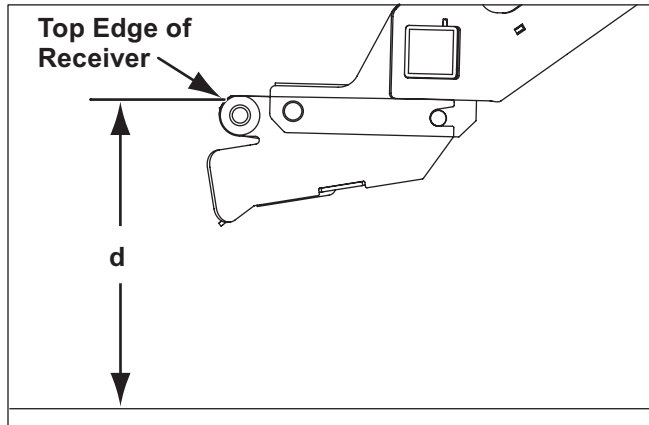

3. Use distance "d" from Step 2 and the following chart to determine the proper T-frame hole to use.

Pivot Plate Hole Chart	
Distance "d"	Hole
17.25" – 18.5"	1*
16.5" – 17.25"	2*
15.25" – 16.5"	1
14.0" – 15.25"	2
12.75" – 14.0"	3

* For these measurements and holes, the adjustment plate kit is required in addition to standard receivers.

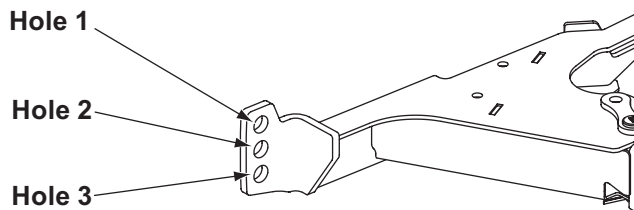

4. If required, install adjustment plates as follows: Position an adjustment plate on each side of the receiver as shown. Insert a 3/4" x 4-1/2" cap screw through the lower front adjustment plate hole and through the appropriate hole on the receiver. Secure with a 3/4" locknut.

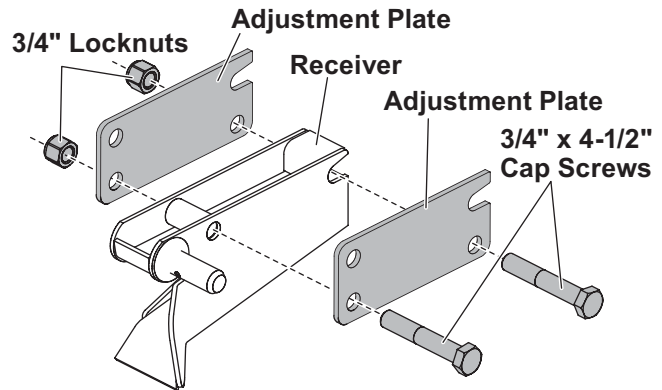

Insert a cap screw through the rear adjustment plate hole, through the slot on the receiver. Secure with a locknut.

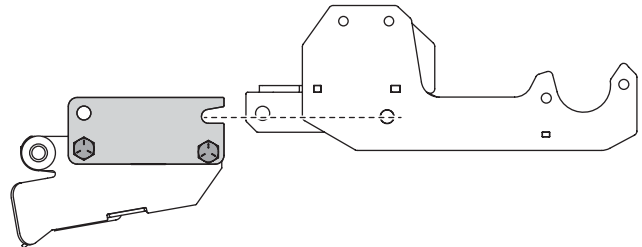

Repeat for the opposite side. Tighten all fasteners to 269 ft-lb.

5. Position the T-frame between the pivot plates, aligning the hole at each end of the pivot bar with the proper pivot plate hole (from Step 3).
6. On each side, insert a 3/4" x 2" clevis pin from the inside of the lift frame through the correct pivot plate holes. Secure the clevis pins with 3/4" flat washers and 5/32" x 1-1/2" cotter pins.

Copyright © 2022 Douglas Dynamics, LLC. All rights reserved. This material may not be reproduced or copied, in whole or in part, in any printed, mechanical, electronic, film, or other distribution and storage media, without the written consent of Western Products. Authorization to photocopy items for internal or personal use by Western Products outlets or snowplow owner is granted.

Western Products reserves the right under its product improvement policy to change construction or design details and furnish equipment when so altered without reference to illustrations or specifications used. Western Products or the vehicle manufacturer may require or recommend optional equipment for snow removal. Do not exceed vehicle ratings with a snowplow. Western Products offers a limited warranty for all snowplows and accessories. See separately printed page for this important information. The following are registered (®) or unregistered (™) trademarks of Douglas Dynamics, LLC: ENFORCER™, UltraMount® 2, WESTERN®.

Printed in U.S.A.