



WESTERN PRODUCTS
7777 NORTH 73RD STREET
P.O. BOX 23045
MILWAUKEE, WISCONSIN 53223

Box No. 60462
Model No. 250
Jeep Cherokee Wagon/Wagoneer
'84 & Later

INSTALLATION INSTRUCTIONS

RECOMMENDED FASTENER TORQUE CHART				
SIZE	TORQUE IN FOOT POUNDS			
	GRADE 2	GRADE 5	GRADE 8	
1/4 - 20	6	9	13	
5/16 - 18	11	18	28	
3/8 - 16	19	31	46	
3/8 - 24	24	46	68	
7/16 - 14	30	50	75	
1/2 - 13	45	75	115	
9/16 - 12	66	110	165	
5/8 - 11	93	150	225	
3/4 - 10	150	250	370	
7/8 - 9	202	378	591	
1 - 8	300	583	893	
METRIC GRADE 8.8 TORQUE IN FOOT POUNDS				
SIZE	TORQUE	SIZE	TORQUE	
M 6	7	M12	60	
M 8	17	M14	95	
M10	35	M16	155	

These torque values apply to lift-mount fasteners except those noted in the instructions where motion is desired.

MINIMUM VEHICLE RECOMMENDATIONS

Aux. Light Kit
Frt. Aux. Air Bag Springs

REAR BALLAST—300 lbs.
when blade is attached.
WEIGHTS MUST BE SECURED.

NOTE:
DIRECT HYDRA-TURN®
HOSES AND FITTINGS
AWAY FROM STOPS
AND PINCH POINTS.

AS VIEWED FROM DRIVER SIDE

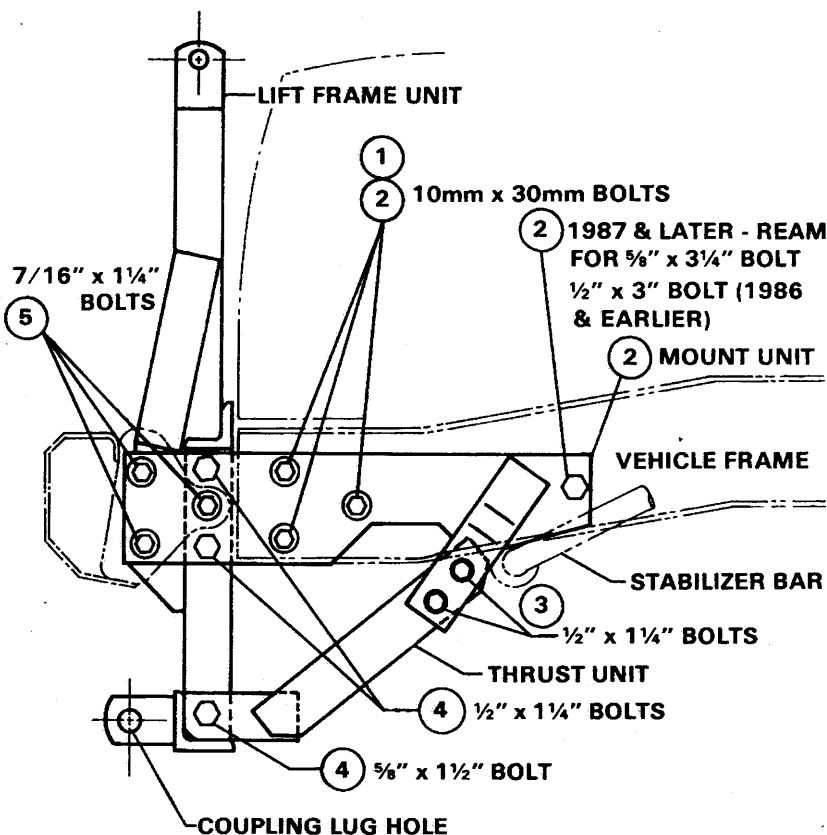

IMPORTANT: Read instructions before assembling. Bolts should be finger tight until the installation is completed to allow sufficient adjustment for aligning holes and locating parts to vehicle frame. Preventive maintenance can prevent accidents. Regularly inspect all components and repair or replace any worn, loose, or damaged parts immediately. Remember to use standard method and practices when attaching snowplow including wearing safety glasses during drilling. Install snowplow as follows:

LIFT-MOUNT ASSEMBLY:

1. Remove bumper with brackets from vehicle. On 1987 and later vehicles, disconnect ball shaped vacuum tank from bottom flange of curb end of bumper.

2. Mount unit installation:

'84 THRU '86: Align mount units to frame bumper bracket attaching holes and fasten with furnished 10mm x 30mm bolts, $\frac{3}{8}$ " flat washers and 10mm lock washers. Secure rear of mount units using furnished $\frac{1}{2}$ " x 3" bolts and locknuts.

'87 AND LATER: Ream the single hole at tapered end of mount unit plates to accept a $\frac{5}{8}$ " bolt. Temporarily loosen rubber mud flaps adjacent to vehicle frame and insert mount units from the rear between frame and front body support bracket. Align mount units to frame bumper bracket attaching holes and fasten using furnished 10mm x 30mm bolts, $\frac{3}{8}$ " flat washers and 10mm lock washers. Secure rear of mount units using furnished $\frac{5}{8}$ " x $\frac{3}{4}$ " bolts and flange nuts. Secure rubber mud flaps.

3. Insert tapped hole ends of right and left hand thrust arm units inside diagonal offset brackets of mount units and secure with furnished $\frac{1}{2}$ " x $\frac{1}{4}$ " bolts and lock washers.

4. Attach Lift Frame Unit to mount plates using furnished $\frac{1}{2}$ " x $\frac{1}{4}$ " bolts and locknuts through top and bottom holes in mount plates. Fasten thrust arms to outside of vertical frame angles using furnished $\frac{5}{8}$ " x $\frac{1}{2}$ " bolts and locknuts.

TIGHTEN ALL BOLTS TO CORRESPONDING TORQUE VALUES NOTED IN FASTENER TORQUE CHART.

5. Loosen bumper brackets on bumper and slide each one out $\frac{1}{4}$ ". Retighten and assemble bumper to outside of mount unit plates using furnished $\frac{7}{16}$ " x $\frac{1}{4}$ " bolts, flat washers to brackets and locknuts. **Replace vacuum tank removed in Step 1.**

CAUTION: To prevent damage to gas lines, brake lines, gas tank vapor lines or wiring during installation, move and replace as necessary.

NOTE: Assemble and install balance of snowplow per instructions furnished with each respective assembly.

Box No. 60462
 Model No. 250
 Jeep Cherokee Wagon/Wagoneer
 '84 & Later

DIAGRAM & PARTS LIST

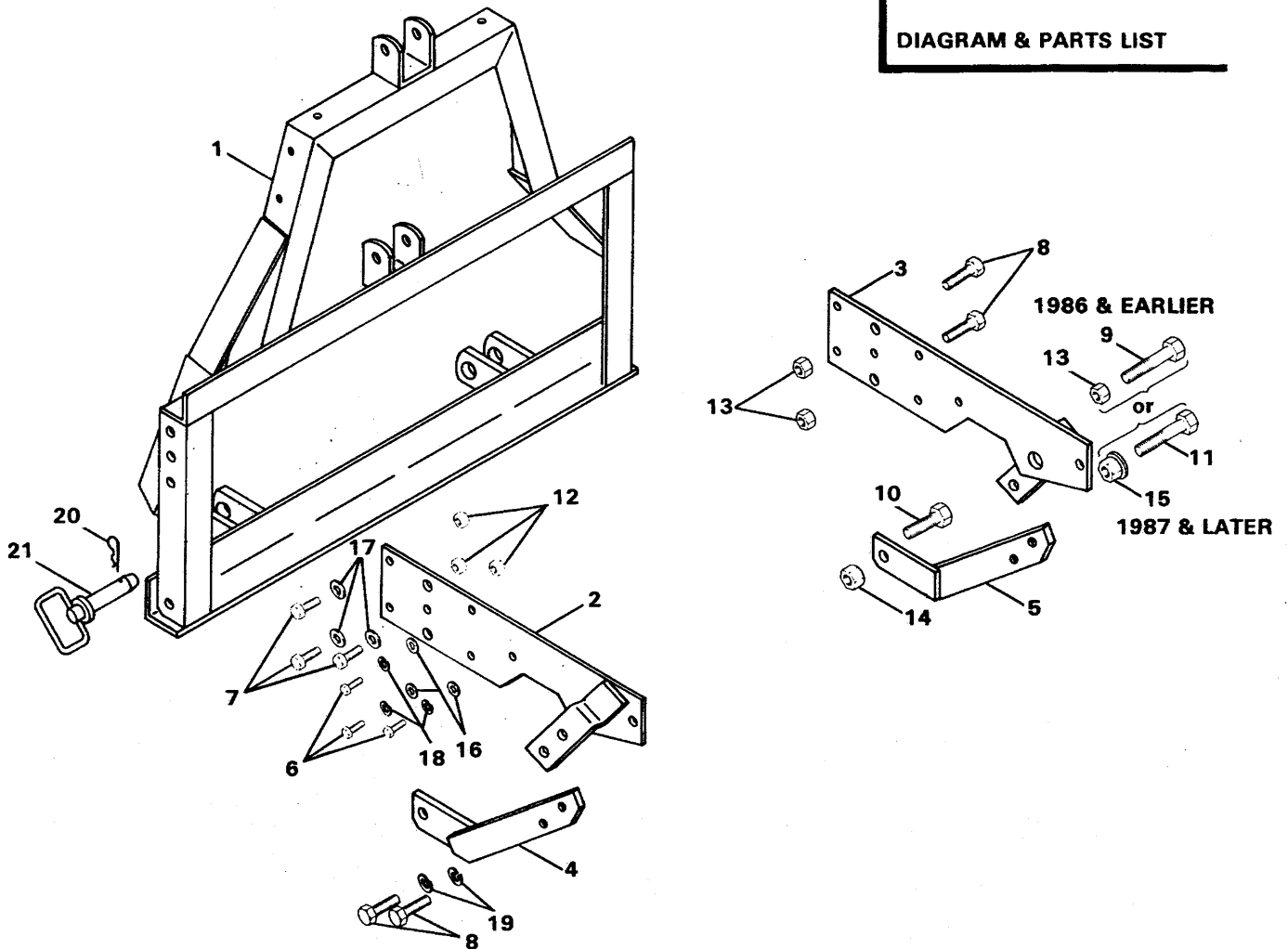

13320-8701

13321-8701

Item	Part No.	Quantity	Description
1	60398	1	Lift Frame Unit
2	60404	1	Mount Unit — Driver Side
3	60405	1	Mount Unit — Curb Side
4	60739	1	Thrust Unit — Driver Side
5	60754	1	Thrust Unit — Curb Side
6	95051	6	Capscrew — 10mm-1.5 x 30mm Long — Grade 8.8
7	90066	6	Capscrew — 7/16"-14 x 1-1/4" Long — Grade 5
8	90099	8	Capscrew — 1/2"-13 x 1-1/4" Long — Grade 5
9	90105	2	Capscrew — 1/2"-13 x 3" Long — Grade 5 ('86 & Earlier)
10	90127	2	Capscrew — 5/8"-11 x 1-1/2" Long — Grade 5
11	90133	2	Capscrew — 5/8"-11 x 3-1/4" Long — Grade 5 ('87 & Later)
12	91334	6	Locknut — 7/16"-14 — Nylon Insert Type
13	91335	6	Locknut — 1/2"-13 — Nylon Insert Type
14	91337	2	Locknut — 5/8"-11 — Nylon Insert Type
15	91382	2	Flange Locknut — 5/8"-11 ('87 & Later)
16		6	Flat Washer — 3/8"
17		6	Flat Washer — 7/16"
18	95173	6	Lock Washer — 10mm
19		4	Lock Washer — 1/2"
20	91965	2	Hairpin Cotter — 5/32" x 2-15/16" O/A Length
21	93028	2	Hitch Pin — 1" x 3-1/2" Long

NOTE: Only those items indicated with a **PART NUMBER** are available for Service.

INSTALLATION INSTRUCTIONS

For IIIa Control and Floor Bracket
Model No. 250
Jeep Cherokee Wagon/Wagoneer
'84 & Later

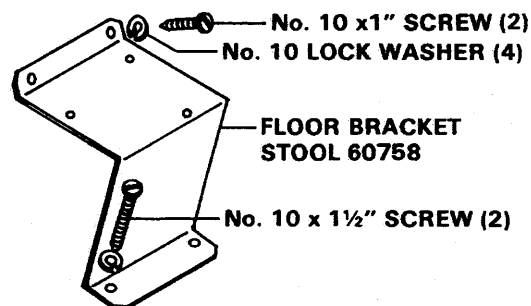
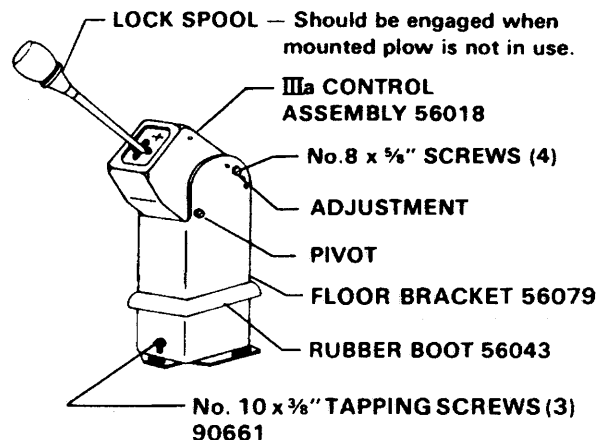
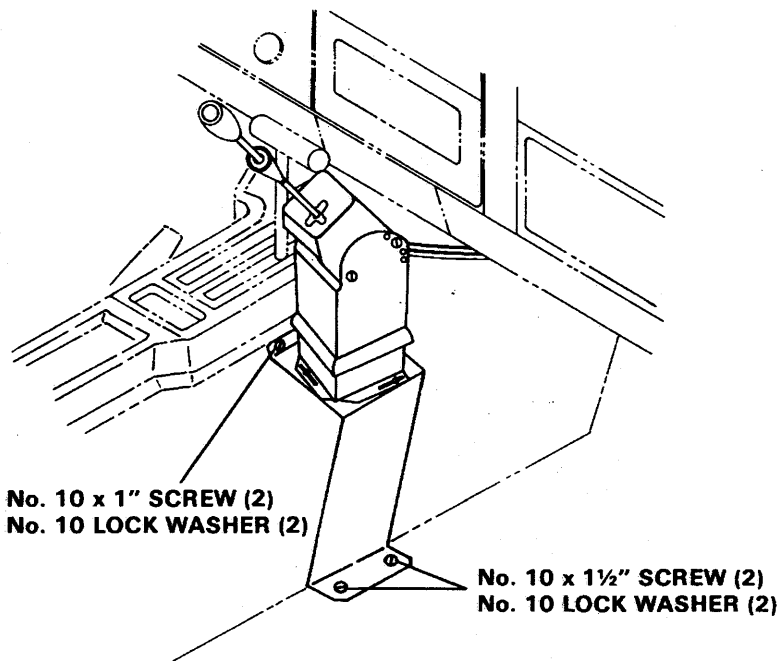

1. Temporarily assemble Floor Bracket to Floor Bracket Stool using three (3) No. 10 x ⅜" long hex head tapping screws. With passenger seat in forward position, place floor bracket and stool assembly as shown to clear front of seat. Check under Stool hole locations for wires or other interference before drilling two (2) 9/64" diameter holes into floor using the Stool as a templet. Secure Stool to floor using two (2) No. 10 x 1½" sheet metal screws and lock washers. Remove Floor Bracket from Stool and drill two (2) 9/64" diameter holes into tunnel using the Stool as a templet. Secure Stool to tunnel with two (2) No. 10 x 1" sheet metal screws and lock washers.
2. Assemble the floor bracket to floor bracket stool using three (3) No. 10 x ⅜" long hex head tapping screws. Place rubber boot onto body of floor bracket.
3. Pass control cables of IIIa Control through holes drilled in the passenger side of firewall. Drill per hydraulic system instructions.
4. Assemble the IIIa Control in desired position to the floor bracket using four (4) No. 8 x ⅝" long hex head screws.
5. Rotate Floor Bracket and Control to desired position and tighten three (3) mounting screws. Slide rubber boot down to cover attaching flange screws.

13322-8701

INSTALLATION INSTRUCTIONS FOR 59700 BLADE GUIDE ASSEMBLY

The following instructions simply outline the attachment of this blade guide assembly.

- Step 1. Lower blade to ground level.
- Step 2. If hole is not pre-drilled, drill one 11/32" hole, 1-3/16" down and 1" out on the outside rib of the blade. See diagram below.
- Step 3. Insert pointed end of clamp into coil of guide. Attach guide to rib using top hole of clamp. Secure assembly using supplied 5/16" x 1" bolt and locknut. Tighten until guide will stand alone perpendicular to road surface.
- Step 4. If hole is not pre-drilled, use lower hole of clamp as locator, drill bottom hole 11/32".
- Step 5. Bolt lower hole in place. Finish securing top bolt.
- Step 6. Attach other side following above steps.

Pictorial view supplied below. Remember to use standard methods and practices in attaching blade guides including wearing safety glasses during drilling.

PARTS LIST 59700 — BLADE GUIDE ASSEMBLY

Item	Part No	Quan.	Description
1	59697	2	Blade Guide Rod, S-Hook & Flag
2	59694	1	Flag
3	59696	1	S-Hook
4	59691	1	Blade Guide Rod
5	59946	2	Clamp
6		4	Capscrew — 5/16"-18 x 1" Gr. 2
7		4	Locknut - 5/16"-18 Nylon Insert

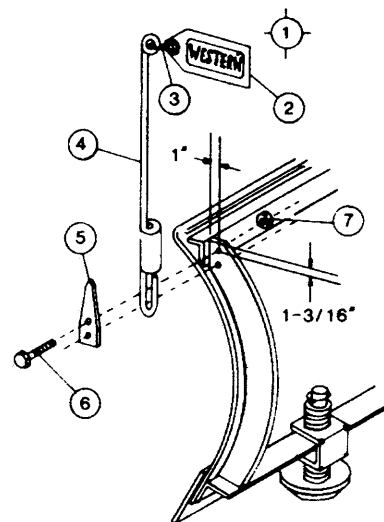

13009-7911

The following are registered® or unregistered™ Trade Marks of Douglas Dynamics, Inc.
WESTERN® ISARMATIC® Hydra-Turn® Roll-Action™

Western reserves the right under its Product Improvement Policy to change construction or design details and furnish equipment when so altered without reference to illustrations or specifications used herein.