



WESTERN PRODUCTS
7777 NORTH 73RD STREET
P.O. BOX 23045
MILWAUKEE, WISCONSIN 53223

 A DIVISION OF DOUGLAS DYNAMICS, INC.

Box No. 61325
Model No. 2350
Toyota 4 x 4 Pickup & 4Runner
1989 & Later

January 7, 1992

PARTS DIAGRAM & LIST

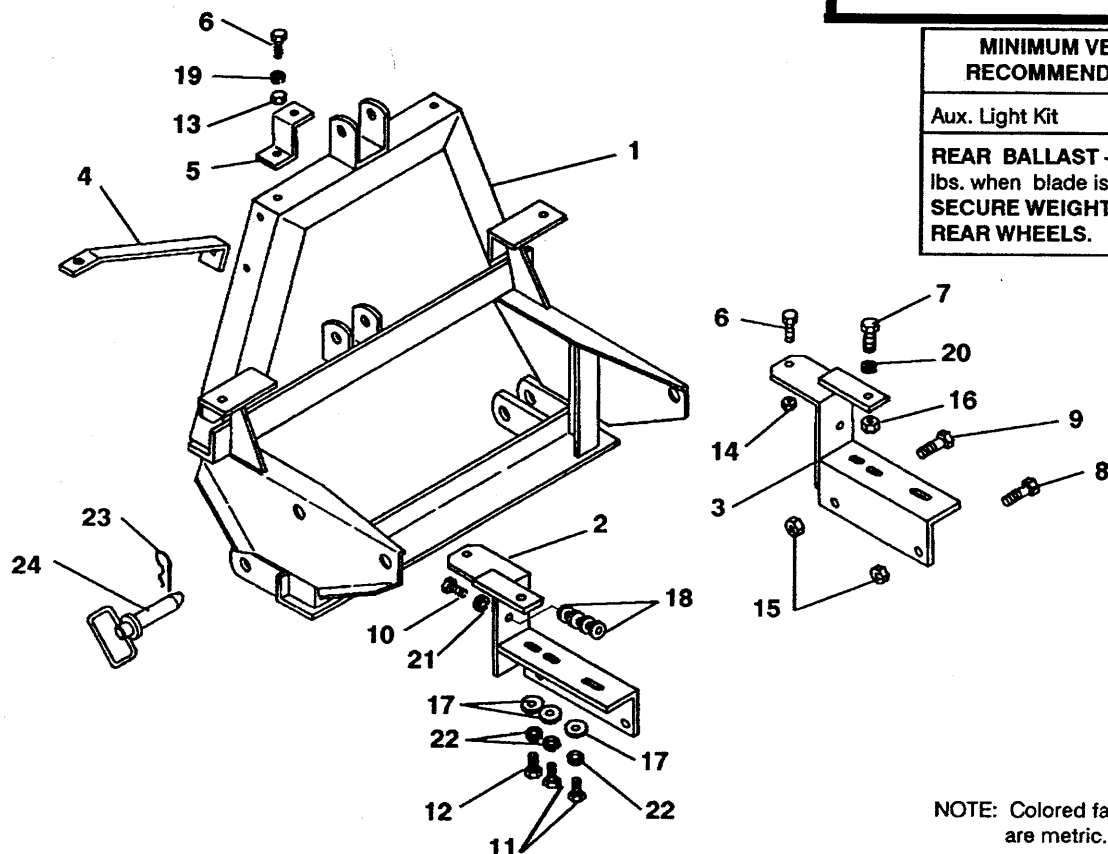

MINIMUM VEHICLE RECOMMENDATIONS

Aux. Light Kit

REAR BALLAST -- 300 to 500
lbs. when blade is attached.
**SECURE WEIGHTS BEHIND
REAR WHEELS.**

NOTE: Colored fasteners
are metric.

ITEM	PART NO.	QUAN.	DESCRIPTION
1	61324	1	LIFT FRAME 2350
2	61336	1	THRUST ARM DR
3	61341	1	THRUST ARM CU
4	60647	2	LIGHT BRACKET BRACE BAR
5	59413	2	LIGHT BRACKET EXTENSION
6	90040	4	3/8-16X1-1/4 HX CS G5 ZP
7	90098	2	1/2-13X1 HX CS G5 ZP
8	90099	2	1/2-13X1-1/4 HX CS G5 ZP
9	90100	2	1/2-13X1-1/2 HX CS G5 ZP
10	95050	2	M10X1.25X30 HX CS G8.8
11	95071	4	M12X1.25X30 HX CS G8.8
12	95072	2	M12X1.25X40 HX CS G8.8
13	91413	2	3/8-16 HX NUT ZP
14	91333	2	3/8-16 PT HX LK NUT NYIS ZP
15	91335	4	1/2-13 PT HX LK NUT NYIS ZP
16	91415	2	1/2-13 HX NUT ZP
17	91104	6	7/16 PLAIN WASHER TY A STD ZP
18	91138	8	7/16 PLAIN WASHER TY A SAE ZP
19	91203	2	3/8 SP LK WASHER ZP
20	91205	2	1/2 SP LK WASHER ZP
21	95173	2	M10 SP LK WASHER
22	95174	6	M12 SP LK WASHER
23	91965K	2	HAIRPIN COTTER 5/32"
24	93028K	2	HITCH PIN 1" X 3-1/2"

Abbreviations	
CS	Capscrew
CU	Curb Side
DR	Driver Side
G	Grade
HD	Heavy Duty
HX	Hex
HXW	Hex Washer
LK	Lock
M	Metric
NYIS	Nylon Insert
PT	Prevailing Torque
SAE	Society of Automotive Engineers
SL	Slotted
SP	Spring
STD	Standard
TCTS	Thread Cutting Tapping Screw
TY	Type
ZP	Zinc Plate

Recommended Fastener Torque Chart (Ft.-Lbs.)					
Size	SAE Grade 2	SAE Grade 5	SAE Grade 8		
1/4-20	6	9	13		
5/16-18	11	18	28		
3/8-16	19	31	46		
3/8-24	24	46	68		
7/16-14	30	50	75		
1/2-13	45	75	115		
9/16-12	66	110	165		
5/8-11	93	150	225		
3/4-10	150	250	370		
7/8-9	202	378	591		
1-8	300	583	893		

Metric Grade 8.8 (Ft.-Lbs.)			
Size	Torque	Size	Torque
M 6	7	M 12	60
M 8	17	M 14	95
M 10	35	M 16	155

These torque values apply to lift-frame fasteners except those noted in the instruction.

NOTE; DIRECT HYDRA-TURN® HOSES AND FITTINGS AWAY FROM STOPS AND PINCH POINTS

Box No. 61325
Model No. 2350
Toyota 4 x 4 Pickup & 4Runner
1989 & Later

INSTALLATION INSTRUCTIONS

AS VIEWED FROM DRIVERS SIDE

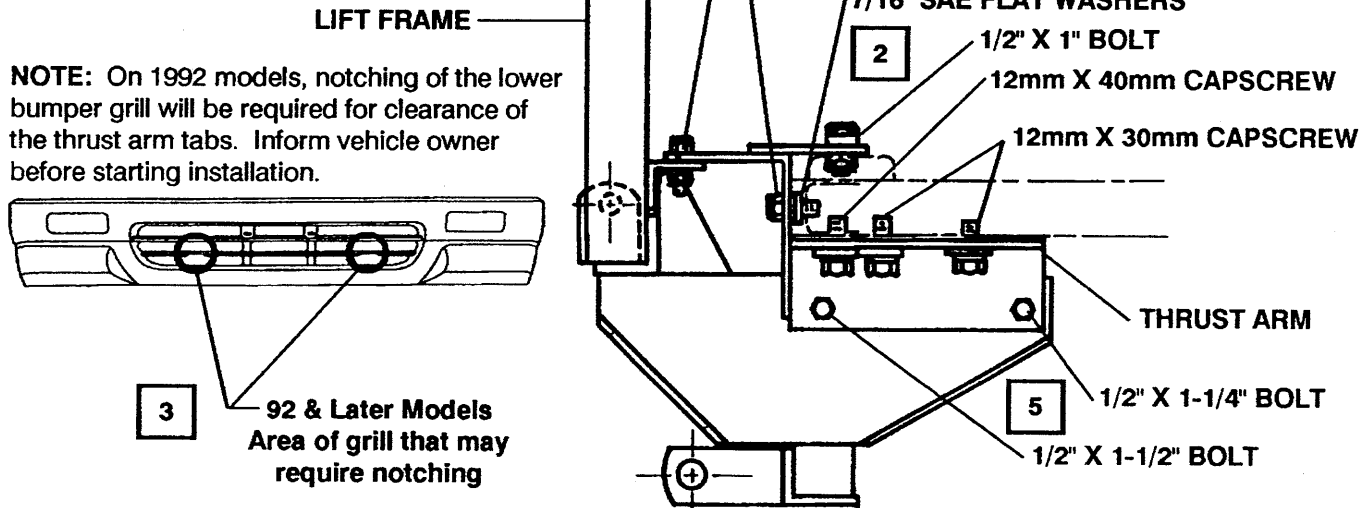

IMPORTANT: Read instructions before assembling. Bolts should be finger tight until the installation is completed. Preventive maintenance can prevent accidents. Use standard methods and practices when attaching snowplow including wearing safety glasses during drilling.

1. Remove turn light lens and pass housing through bumper opening. Remove bumper with brackets, tow hook and tie down bracket. Retain tow hook and tie down bracket for replacement if lift mount is removed from vehicle.
2. Install Thrust Arms to frame rails aligning front slots of angle to tow hook or tie down bracket mounting holes. On each side, select correct number (one to four) of 7/16" SAE flat washers to fill gap between front cross member and Thrust Arm vertical flat bars. Slide Thrust Arms forward, insert 10mm x 30mm capscrews with 10mm lock washers thru flat bar hole and SAE washers. Slide Thrust Arm into place and finger tighten capscrew. Attach upper tab to body support on top of frame rail with 1/2" x 1" capscrew and lock washer inserted from top into nut held inside body support. Attach angle to bottom of frame rail with 12mm x 40mm capscrews in front slot and 12mm x 30mm capscrews in two rear slots, 7/16" standard flat washers to slots and 12mm lock washers. Torque 10mm capscrew and then top and bottom capscrews to corresponding torque chart values.
3. 1992 Model vehicles only – Replace bumper to its original position to determine notch locations. Notch bumper removing only material required to reinstall bumper.
4. Replace bumper and turn lights.
5. Attach Lift Frame to underside of tabs through grill with 3/8" x 1-1/4" bolts and locknuts. Attach side plates to Thrust Arm angles with 1/2" x 1-1/4" bolts in rear holes and 1/2" x 1-1/2" bolts in front holes and locknuts. Torque all bolts to corresponding torque chart values.

LIGHT KIT ASSEMBLY - Use Box No. 60750 Headlamp Kit - 5 Wire and Box No. 60755 Harness Bracket Kit - 2B/2D 5 Wire NF. Replace vehicle flasher (found in floor bracket carton in lift mount box) located on a bracket on the underside of dash just to left of steering column. Use 3/8" x 1-1/4" bolts, lock washers and hex nuts to install 59413 Light Bracket Extensions furnished in Lift Mount Box as shown in Parts Diagram, page 1. Replace 60005 and 60006 Light Bracket Brace Bars furnished in 60755 Harness Bracket Kit with 60647 Light Bracket Brace Bars furnished in Lift Mount Box.

NOTE: Assemble and install balance of snowplow per instructions furnished with each respective assembly.

INSTALLATION INSTRUCTIONS
FOR — Ila CONTROL

TOYOTA 4 X 4 PICKUP & 4RUNNER
1989 & LATER

1. Secure floor bracket to stool, using 3-No. 10 x 3/8" long hex head tapping screws.
2. Move seat to completely forward position. Locate floor bracket and stool assembly next to tunnel with floor bracket against forward edge of seat and mark location of four (4) mounting holes.
3. **NOTE:** Before drilling — remove speedometer cable from bracket under floor panel. Drill two (2) 9/64" diameter holes into floor and two (2) 9/64" holes into tunnel. **DO NOT** drill into plastic collar surrounding shift levers.
4. Remove floor bracket from stool. Install stool using four (4) No. 10 x 1" sheet metal screws and lock washers.
5. Install floor bracket on top of stool using three (3) No. 10 x 3/8" long hex head tapping screws. Rotate to desired position towards drivers seat before tightening.
6. Slide rubber boot into position over top of floor bracket.
7. Assemble the Ila Control to the floor bracket using four (4) No. 8 x 5/8" long hex head screws, passing control cables through the passenger side firewall (drill per Hydraulic System Instructions).
8. Reinstall speedometer cable into mounting bracket (removed in Step 3).

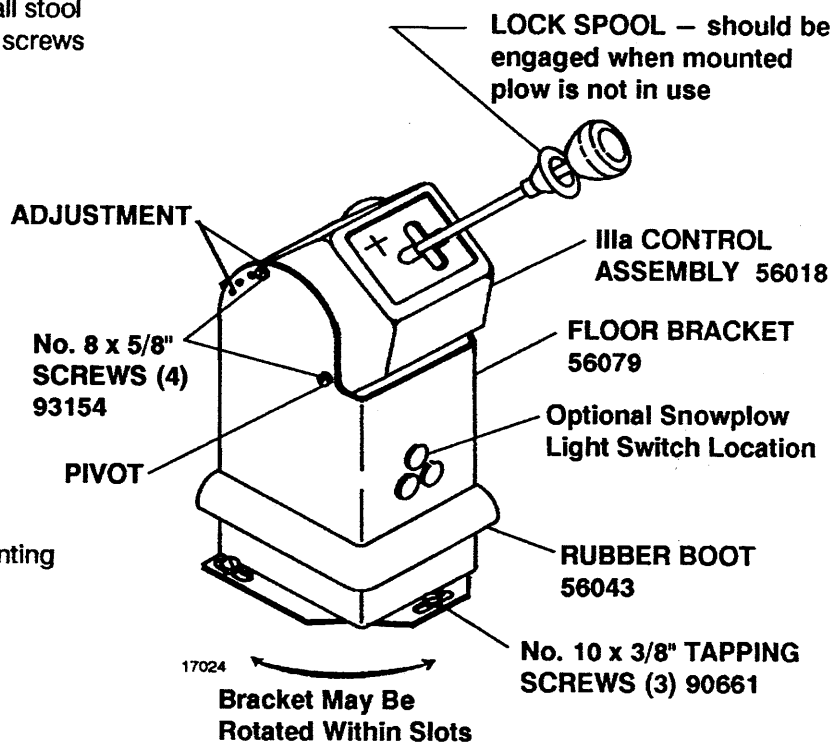
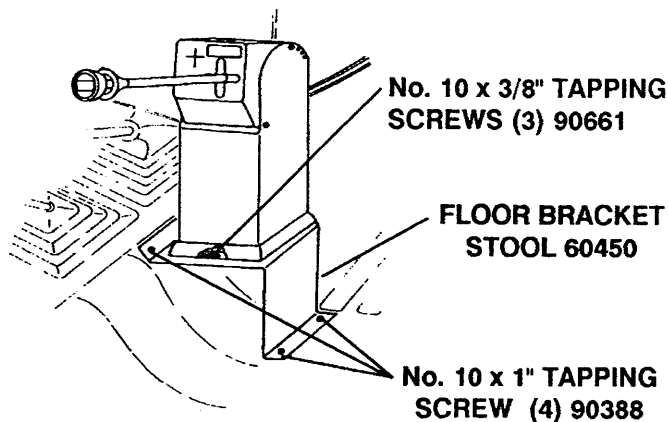

INSTALLATION INSTRUCTIONS FOR 59700 BLADE GUIDE ASSEMBLY

Insert pointed end of clamp into coil of Blade Guide Rod. Attach a Blade Guide Rod to each outer rib using 5/16" x 1" capscrews and locknuts as shown in diagram..

PARTS LIST

59700 – BLADE GUIDE ASSEMBLY

Item	Part No.	Quan.	Description
1	59697	2	BLADE GUIDE ROD, S-HOOK & FLAG
2	59694K	1	BLADE GUIDE FLAG
3	59696	1	S-HOOK
4	59691	1	BLADE GUIDE ROD
5	59946	2	CLAMP
6	90020	4	5/16-18X1 HX CS G2 ZP
7	91332	4	5/16-18 PT HX LK NUT NYIS ZP

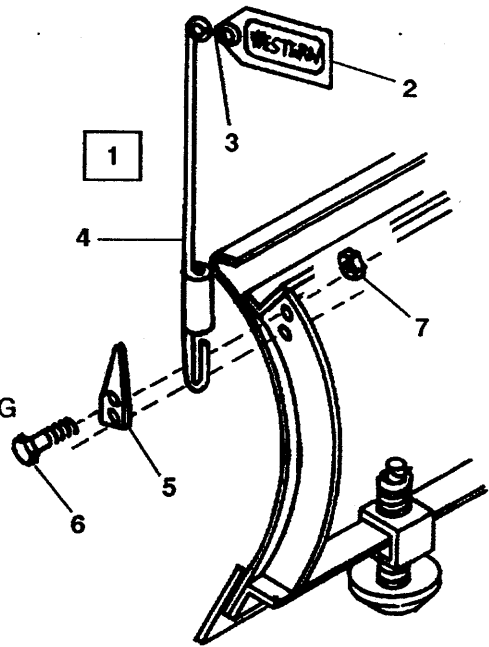

13009-8908

The following are registered® and unregistered™ Trade Marks of Douglas Dynamics, Inc.
WESTERN® ISARMATIC® Hydra-Turn® UniMount® Roll-Action™ PRO-GUARD™

Western reserves the right under its Product Improvement Policy to change construction details and furnish equipment when so altered without reference to illustrations or specifications used herein.