

ISARMATIC® Mark III HYDRAULIC UNIT

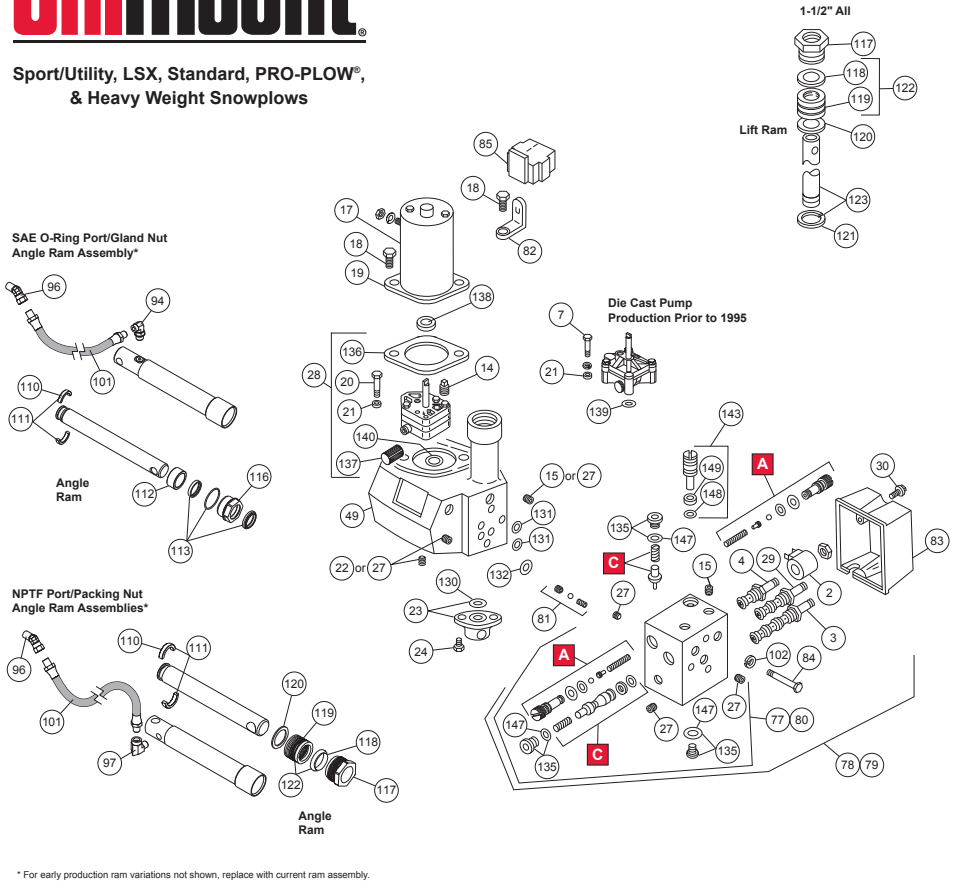

Sport/Utility, LSX, Standard, PRO-PLOW®, & Heavy Weight Snowplows



* For early production ram variations not shown, replace with current ram assembly.

MVP® HYDRAULIC UNIT



MVP MULTIPOSITION V PLOW

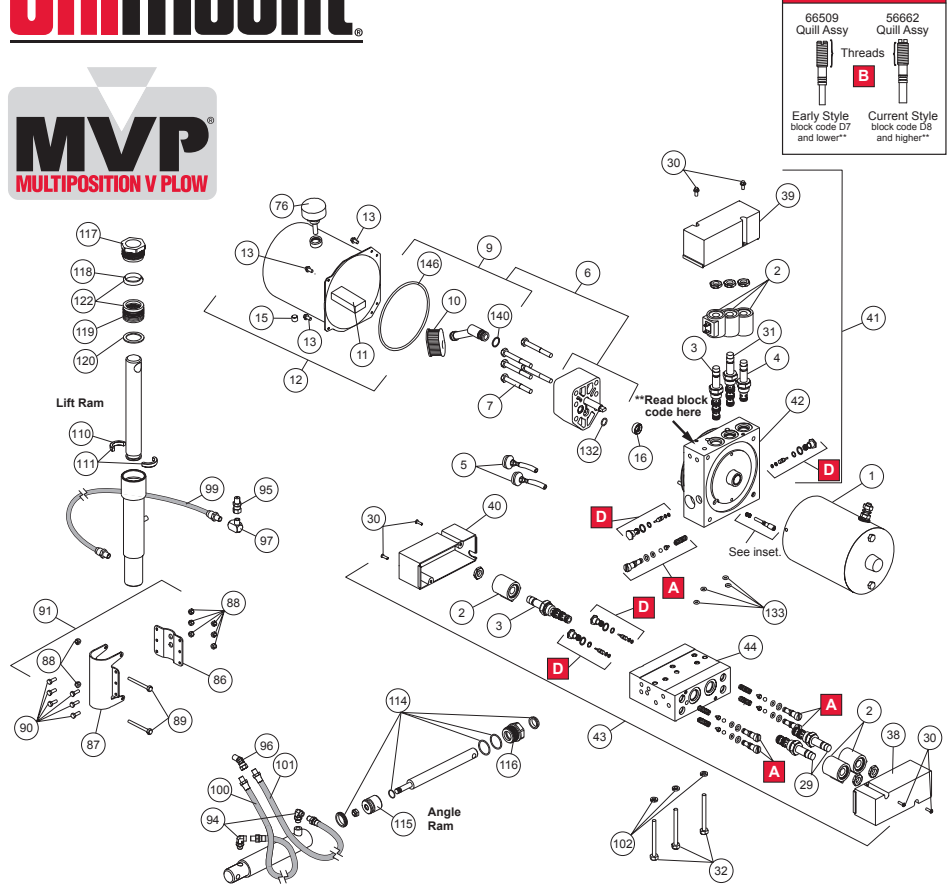

CABLE CONVENTIONAL HYDRAULIC UNIT

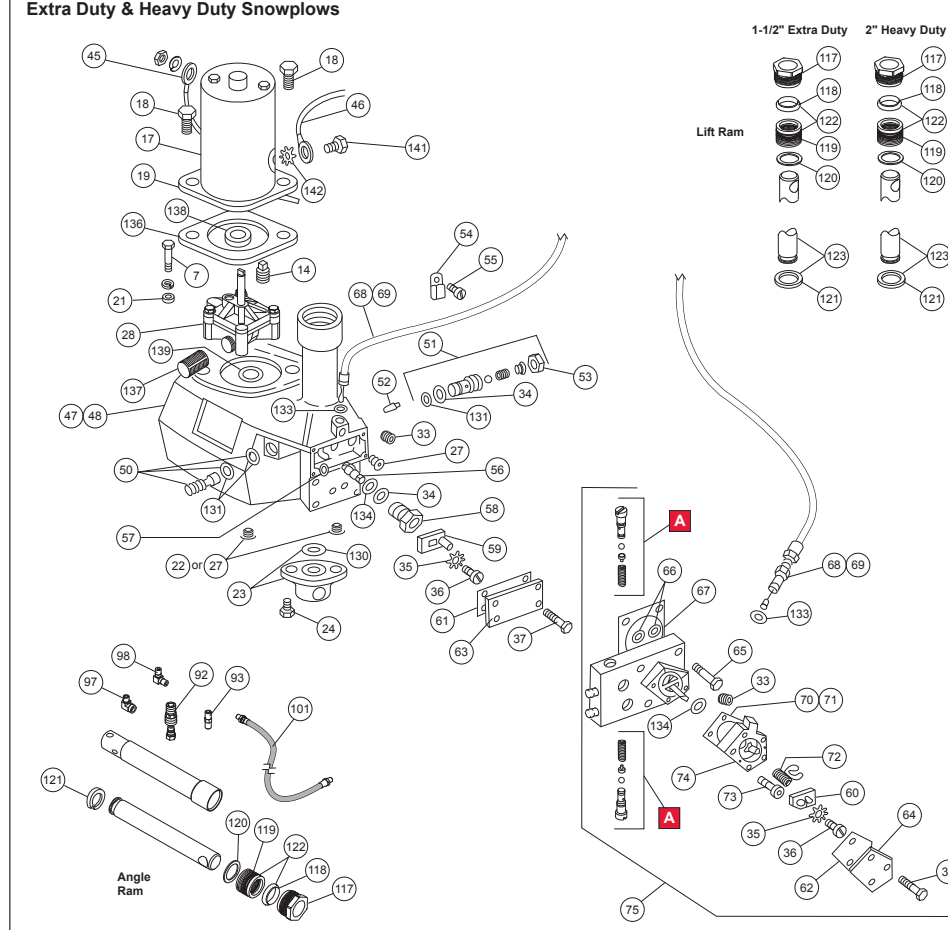

Rams

Part:	Lift Rams				Single-Acting Angle Rams				DA Angle Ram
	66722	62540	56538K	62550K	25878K	56709W			
Fitting Type:	N/A	N/A	N/A	NPTF	NPTF	SAE	NPTF	NPTF	NPTF
Application:	ISARMATIC	Conventional ED	Conventional HD	MVP	Sport/Utility	LSX	Standard & PRO-PLOW	Heavy Weight	MVP
Item	Description								
110	Split Bearing, 1-1/2"								
111	Split Bearing Kit, 1-1/2"								
112	Spacer								
113	Seal Kit with PolyPak Seal 1-1/2" Ram								
114	Seal Kit 2" DA Ram (single groove)								
115	Seal Kit w/Piston, 2" DA Ram (2 groove)								
116	Gland Nut - PolyPak Seal								
117	Packing Nut								
118	Wiper Ring								
119	Packing Set								
120	Washer - Special								
121	Retainer Ring								
122	Packing Set with Wiper								
123	Plunger Assembly								

Common Valve & Quill Assys

Assembly A
49138K-3 Relief Valve Kit (2 sets)

Assembly B
66509 or 56662 Quill Assembly

Assembly C
49226K Poppet Check Valve Kit

Assembly D
66785 Pilot Check Valve Kit

56657-3 O-Ring & Back-Up Ring Kit – SOL

Item	Part	Qty	Description	Item	Part	Qty	Description
130	25618	1	O-Ring - 216	147	26784	4	O-Ring - 903
131	25730	2	O-Ring - 012	148	25622	2	O-Ring - 006
132	56274	1	O-Ring - 013	149	56315	2	Back-Up Ring - 006
133	25731	9	O-Ring - 010	150	66627	4	O-Ring - 011
134	55371	5	O-Ring - 008, 90 Durometer (black)	151	66628	4	Back-Up Ring - 008
135	92960	3	3/8"-24 Hx So O-Ring Boss Plug	152	56569	4	O-Ring - 906
136	25861K	1	Motor Gasket Kit	153	56776	4	O-Ring - 008, 70 Durometer (Red)
137	56185K	1	Suction Filter	ns	66028	1	O-Ring - 226
138	49014	1	Oil Seal				
139	25620	1	O-Ring - 115				

(Universal Kit - not all contents are used in each blade application.)

49340 Major Overhaul Kit

Item	Part	Qty	Description	Item	Part	Qty	Description
140	56416	1	O-Ring - 014	141	90088	1	5/16"-18 x 1/2" Hex Cap Screw
141	90088	1	5/16"-18 x 1/2" Hex Cap Screw	142	91263	1	5/16" External Lock Washer
142	91263	1	5/16" External Lock Washer	143	56330	1	Quill Assembly
143	56330	1	Quill Assembly	144	55137	1	Wiper Ring 1-1/2"
144	55137	1	Wiper Ring 1-1/2"	145	55136	1	Packing Set 1-1/2"
145	55136	1	Packing Set 1-1/2"	ns	49258-2	1	Seal Kit - Cartridge 20
146	49226K	1	Poppet Check Valve Kit	ns	49259-2	2	Seal Kit - Cartridge 30, 31, 33, 40 & 43

(ISARMATIC and Cable ISARMATIC Systems Only)

PARTS LIST

Item	Part	Description	Item	Part	Description	Item	Part	Description
1	21500-1	Motor Assembly 4-1/2" - FS	37	90666	SEMS TCTS SL HX #10-24 x 5/8" TY	70	55951	Shim Spacer .0005 Silver
2	49230K-2	Coil with Spade Terminals	38	66397	Cover Assembly V-Plow 3-3	71	55735	Shim Spacer .00035 Clear
3	49229K-1	Cartridge 40 with Jam Nut	39	66396	Cover Assembly V-Plow 4-4-2	72	55359	Torsion Spring
4	49227K-2	Cartridge 20 with Jam Nut	40	66398	Cover Assembly V-Plow 4-Way	73	90909	1/4"-20 x 1-1/2" Socket Cap Screw
5	66405	Return Screen Assembly	41	66774	Primary Manifold w/Cartridges, Coils & Covers	74	55342	Cable and Linkage Enclosure
6	21501-1	Hyd Pump Kit - FS	42	66776	Primary Manifold w/o Cartridges, Coils & Covers	75	49020	Valve Kit 4W
7	90073	5/16"-18 x 2-1/4" Hex Cap Screw G5	43	66786	Secondary Manifold w/Cartridges, Coils & Covers	76	66525	Reservoir Filler Breather Plug
8	66763-1	Inlet Fitting/Filter Kit	44	66772-1	Secondary Manifold w/o Cartridges, Coils & Covers	77	49224	Manifold Assy w/o cart SOL 3500
9	56789-3	Suction Filter	45	25635K	Battery Cable 60" Red	78	49278	Valve Manifold Assy SOL 2500
10	56984	Magnet	46	55984	Ground Cable 60" Black	79	49265	Valve Manifold Assy SOL 3500
11	66631	Reservoir Kit MVP	47	55946	Service Housing Kit 1-1/2"	80	49279	Manifold Assy w/o cart SOL 2500
12	66607	10-24 x 5/16" Machine Screw	48	55945	Service Housing Kit 2"	81	49225	Inlet Check Valve
13	92079	Plug 3/8" NPTF SQ	49	49252	Service Housing Kit 1-1/2" SOL	82	56356	Boot Bracket Kit
14	92095	Plug 1/4" NPTF Hx So Thread Seal	50	49064K	Lift Valve with two #25730 O-Rings	83	56291	Cover Assembly
15	66515	Pump Shaft Seal	51	55568K	Check Valve Assembly	84	90083	1/4"-20 x 3-1/4" Hex Cap Screw G5
16	56133	Motor Assembly 4-1/2"	52	55570	Shuttle	85	61246	Cable Boot
17	90066	7/16"-14 x 1-1/4" Hex Cap Screw G5	53	55569	5/8"-18 Hex Jam Nut Special	86	56504	Cylinder Mounting Bracket
18	49084	Motor Flange Brg & Seal	54	55381	Cable Clamp	87	67387	Cylinder Mounting Bracket
19	90080	5/16"-18 x 2-1/2" Hex Cap Screw G5	55	90388	10-16 x 1" Tapping Screw	88	91331	1/4"-20 Hex Locknut GB
20	90311	1/4" Flat Washer	56	55571	Cam Shaft	89	90010	1/4"-20 x 2-3/4" Hex Cap Screw G5
21	92072	Plug 1/4" NPTF HX SO - with fluid level plug	57	55591	Expansion Plug 1/4"	90	90461	1/4"-20 x 3/4" Hex Cap Screw G5
22	25968K	Base Lug with #25618 O-Ring	58	55572	Hub Nut	91	66778	Mounting Bracket Kit
23	93166	5/16"-18 x 1-1/4" Tapping Screw	59	55573	Valve Lever Assembly	92	25322K	Quick Coupler
24	92071	Plug 1/8" NPTF HX SO without fluid level plug	60	55364	Valve Lever Assembly 4W	93	25519K	Hex Nipple 1/4"
25	49211	Hydraulic Pump Kit	61	55350	Cover Gasket 3W	94	56539K	Elbow, 90° - 6 O-Ring/1/4" NPTF
26	49228K-1	Cartridge 30 with Jam Nut	62	55357	Cover Gasket 4W	95	66562K	Straight Union Adapter Kit
27	90650	8-32 x 1/2" Tapping Screw	63	55958	Enclosure Cover 3W	96	92190K	Swivel Hose Fitting 1/4" NPTF x 45
28	66783W	Cartridge 43 with Jam Nut	64	55959	Enclosure Cover 4W	97	92210K	Street Elbow 1/4" x 90
29	66597	1/4"-20 x 2-1/2" Hex Cap Screw G5	65	93165	1/4"-20 x 1-3/4" Tapping Screw	98	92278K	Male Elbow 1/4" x 90 SPL
30	90600K	Cable Retainer Screws	66	55252	O-Ring - 015	99	56224K	1/4" x 18" Pressure Hose Kit
31	55587	O-Ring - 112	67	55374	Manifold Gasket 4W	100	4424K	1/4" x 36" High Pressure Hose Kit
32	91259	6 External Lock Washer	68	56130	Cable Assembly 9" Black Adjust	101	55020K	1/4" x 38" Pressure Hose Kit
33	90598	6-32 x 1/4" Machine Screw	69	56180	Cable Assembly 12" Black Adjust	102	91201	1/4" Spring Lock Washer



Western Products
PO Box 245038 • Milwaukee, WI 53224-9538
Use only genuine WESTERN® replacement parts.

Copyright © 2009 Douglas Dynamics, L.L.C. All rights reserved. This material may not be reproduced or copied, in whole or in part, in any printed, mechanical, electronic, film or other distribution and storage media, without the written consent of Western Products. Authorization to photocopy items for internal or personal use by Western Products outlets or snowplow owner is granted.

Western Products reserves the right under its product improvement policy to change construction or design details and furnish equipment when so altered without reference to illustrations or specifications used. Western Products or the vehicle manufacturer may require or recommend optional equipment for snow removal. Do not exceed vehicle ratings with a snowplow. Western Products offers a limited warranty for all snowplows and accessories. See separately printed page for this important information. The following are registered (®) trademarks of Douglas Dynamics, L.L.C.: ISARMATIC®, MVP®, PRO-PLOW®, UniMount®, WESTERN®.

INTERACTIVE PARTS POSTER AVAILABLE AT WWW.WESTERNPLOW.COM