



WESTERN PRODUCTS
7777 NORTH 73RD STREET
P.O. BOX 23045
MILWAUKEE, WISCONSIN 53223



A DIVISION OF DOUGLAS DYNAMICS, INC.

Box No. 60470
Model 1550
Chev/GMC "S" SERIES 4x4
Front Frame Lift-Mount

March 22, 1990

PARTS DIAGRAM & LIST

MINIMUM VEHICLE RECOMMENDATIONS
Aux. Light Kit HD Alternator HD Battery HD Torsion Bars
REAR BALLAST - 300 to 500 lbs. when blade is attached. WEIGHTS MUST BE SECURED.

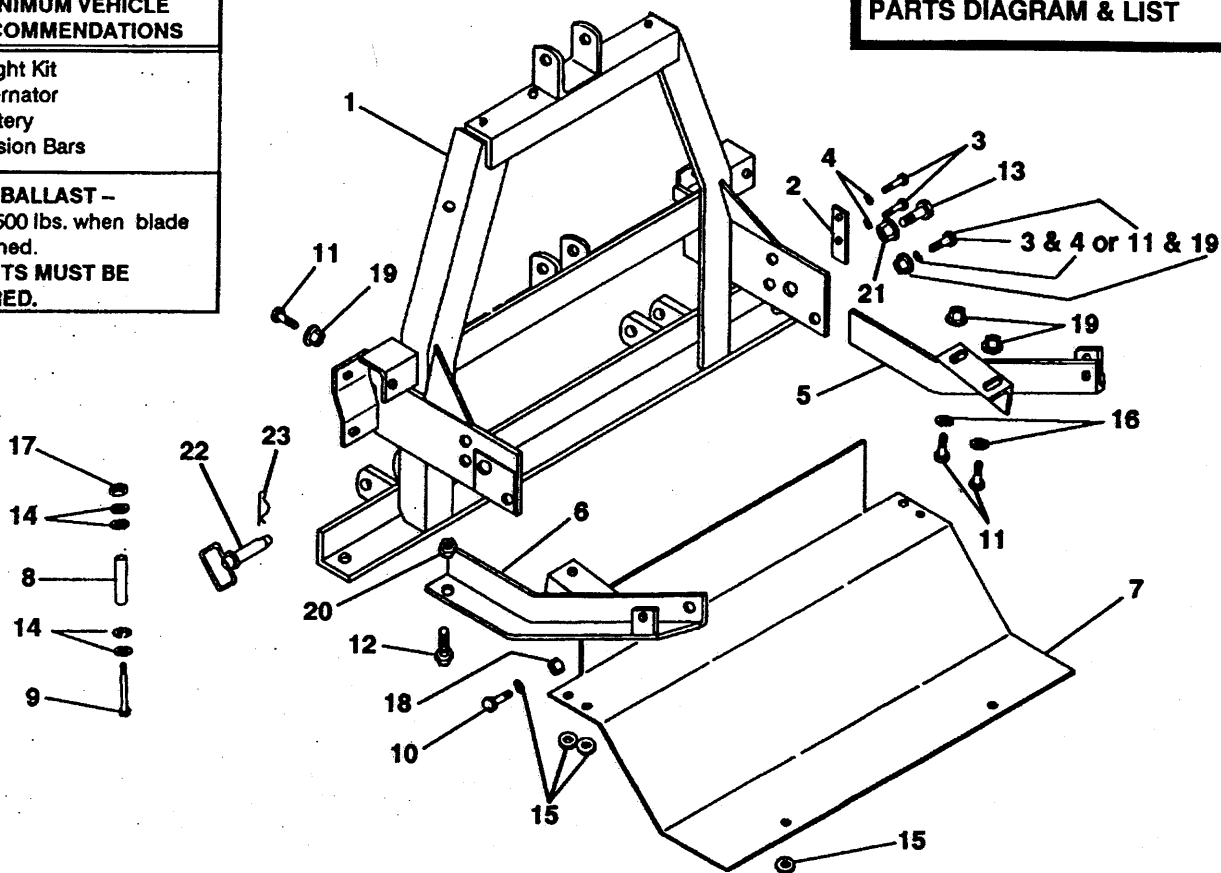

ITEM	PART NO.	QUAN.	DESCRIPTION
1	49091	1	LIFT-MOUNT REPLACEMENT KIT
2	60477	2	SPACER (1983-84)
3	95051	6	M10X1.5X30 HX CS G8.8 (1983-84)
4	95173	6	M10 SP LK WASHER (1983-84)
5	60475	1	THRUST ARM CU
6	60473	1	THRUST ARM DR
7	61298	1	SPLASH SHIELD
8	60265	2	SPACER
9	90014	2	1/4-20X3-1/2 HX CS G2 ZP
10	90040	2	3/8-16X1-1/4 HX CS G5 ZP
11	90066	8	7/16-14X1-1/4 HX CS G5 ZP
12	90100	2	1/2-13X1-1/2 HX CS G5 ZP
13	90127	2	5/8-11X1-1/2 HX CS G5 ZP
14	91101	8	1/4 PLAIN WASHER TY A STD ZP
15	91103	8	3/8 PLAIN WASHER TY A STD ZP
16	91104	2	7/16 PLAIN WASHER TY A STD ZP
17	91331	2	1/4-20 PT HX LK NUT NYIS ZP
18	91333	2	3/8-16 PT HX LK NUT NYIS ZP
19	91380	8	7/16-14 PT HX FLG LK NUT ZP
20	91335	2	1/2-13 PT HX LK NUT NYIS ZP
21	91382	2	5/8-11 PT HX FLG LK NUT ZP
22	93028K	2	HITCH PIN 1" X 3-1/2"
23	91965K	2	HAIRPIN COTTER 5/32"

Abbreviations	
CS	Capscrew
CU	Curb Side
DR	Driver Side
FLG	Flange
G	Grade
HX	Hex
LK	Lock
M	Metric
NYIS	Nylon Insert
PT	Prevailing Torque
SP	Spring
STD	Standard
TY	Type
ZP	Zinc Plated

PARTS NOT SHOWN

55930

1

BATTERY CABLE ADAPTER

Recommended Fastener Torque Chart (Ft.-Lbs.)				
Size	SAE	SAE	SAE	
	Grade 2	Grade 5	Grade 8	
1/4-20	6	9	13	
5/16-18	11	18	28	
3/8-16	19	31	46	
3/8-24	24	46	68	
7/16-14	30	50	75	
1/2-13	45	75	115	
9/16-12	66	110	165	
5/8-11	93	150	225	
3/4-10	150	250	370	
7/8-9	202	378	591	
1-8	300	583	893	

Metric Grade 8.8 (Ft.-Lbs.)			
Size	Torque	Size	Torque
M 6	7	M 12	60
M 8	17	M 14	95
M 10	35	M 16	155

These torque values apply to lift-frame fasteners except those noted in the instruction.

Box No. 60470
Model 1550
Chev/GMC "S" SERIES 4x4
Front Frame Lift-Mount

March 22, 1990

INSTALLATION INSTRUCTIONS

**NOTE; DIRECT
HYDRA-TURN®
HOSES AND FIT-
TINGS AWAY
FROM STOPS AND
PINCH POINTS**

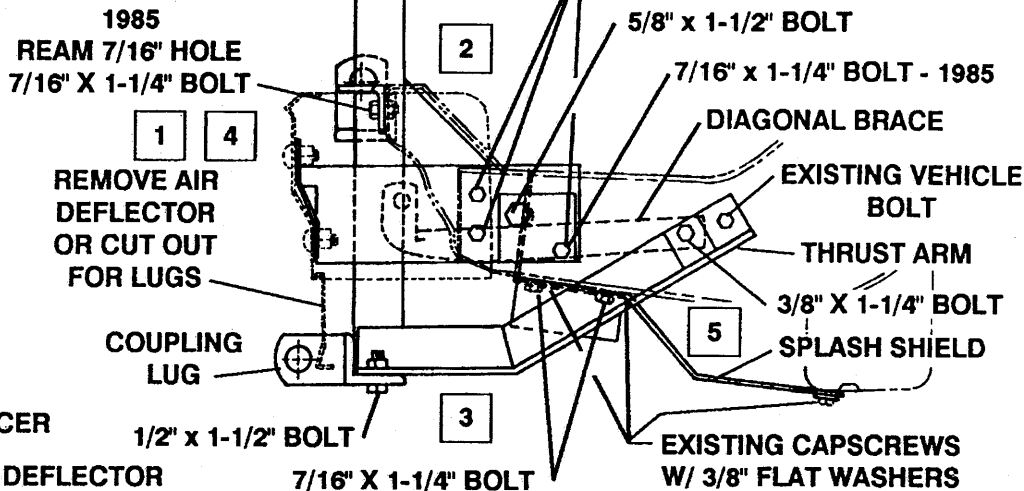
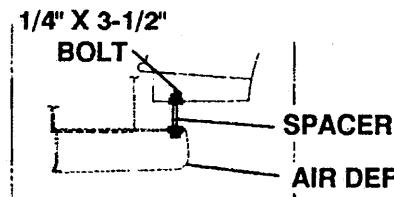

IMPORTANT: Read instructions before assembling. Bolts should be finger tight until the installation is completed. Preventive maintenance can prevent accidents. Use standard methods and practices when attaching snowplow including wearing safety glasses during drilling.

- 1990 and Later:** Open hood and remove grille (8 screws). Detach marker lights as grille is removed. Remove bumper with air deflector and diagonal braces as a unit. Remove splash shield and tow hooks. Replace marker lights to grille and grille to vehicle.
1985-89: Remove bumper, grille, one (1) headlamp bezel, and the bottom inside fastener of opposite headlamp bezel. Remove bumper, air deflector and diagonal braces as a unit. Remove splash shield and tow hooks. Replace grille, headlamp bezel, and fastener of opposite headlamp bezel.
1983-84: Remove splash shield. Remove the bumper with brackets, air deflector and diagonal braces as a unit, and then the brackets from the bumper. Remove tow hooks if equipped.
- 1990 and Later**
1985-89: Place Lift Frame to inside of vehicle frame from below and align large hole and rear small hole in side plates to the slot and rearward small hole in frame. Fasten with 5/8" x 1-1/2" bolt and flange locknut to slot and 7/16" x 1-1/4" bolt and flange locknut to small hole. **NOTE:** Ream 7/16" hole if necessary. Use breaker bar and socket or box wrench to assist installation of locknuts inside frame box section.
1983-84: Place Lift Frame to inside of vehicle frame with Lift Frame side plates aligning to the three bumper bracket holes and the large slot in the frame. Slip spacer between Lift Frame and vehicle frame, aligning to the front two bumper bracket holes. Secure Lift Frame with three (3) 10mm x 30mm bolts and lock washers into cage nuts and one (1) 5/8" x 1-1/2" bolt and flange locknut per side.
- ALL VEHICLES:** With front of Thrust Arm on top of Lift Frame bottom cross angle, attach the rear end using existing fastener into cage nut where diagonal brace was removed. Align the two (2) holes in the Thrust Arm angle clip to the holes in the bottom of the vehicle frame (tow hook holes), use flat washers to slots (curb side only), and secure with 7/16" x 1-1/4" bolts and flange locknuts OR use tow hook fasteners into threaded bar in frame. Attach front end of the Thrust Arms to Lift Frame using 1/2" x 1-1/2" bolts and locknuts.

TIGHTEN ALL BOLTS TO CORRESPONDING TORQUE CHART VALUES.

- 1990 and Later**
1985-89: Using the bumper bracket attaching tabs as a template, ream hole in bumper brackets to 7/16" and secure with 7/16" x 1-1/4" bolts and flange locknuts.

5. **ALL VEHICLES:** Reattach vehicle splash shield if it fits OR install furnished splash shield using existing capscrews and furnished 3/8" flat washers. Loosen diagonal braces on bumper. **OPTION:** Air deflector may be removed OR cut notches for coupling lug clearance. Assemble bumper to Lift Frame with existing fasteners. Attach diagonal braces to the inside of the Thrust Arm tabs using 3/8" x 1-1/4" bolts, flat washers to slots and locknuts. If air deflector is installed, drill 5/16" holes into bottom flange of front fender skirt matching to holes in air deflector. Secure with Spacer, 1/4" x 3-1/2" bolts, flat washers and locknuts. **NOTE:** Retain any parts removed and not reinstalled for future use if snowplow is removed from vehicle.

After completion of plow installation, the torsion bar suspension may be adjusted to maintain the 11-3/4" to 12-1/4" coupling lug height. Alternate driver and curb side adjustment for uniform height change. After each series of adjustments, bounce vehicle three times to flex suspension prior to measuring.

HYDRAULICS: Mount Hydraulic System per instructions.

LIGHT KIT ASSEMBLY — Use Box No. 60740 Headlamp Kit - 4 Wire and Box No. 60745 Harness Bracket Kit - 2B/2D.

INSTALLATION INSTRUCTIONS for SOLENOID CONTROL 1986 AND LATER VEHICLES

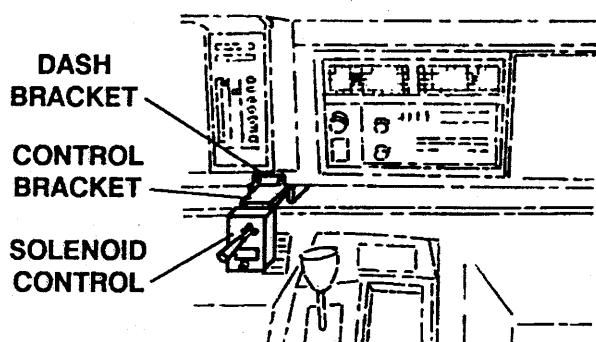

1. Secure Solenoid Control to Control Bracket using two (2) No. 8 x 5/8" hex head screws, and Control Bracket to Dash Bracket using four (4) No. 8 x 3/8" hex head thread cutting screws.
2. Locate assembly to dash opening below and to the left of the radio. The Dash Bracket should fit fairly flat against dash/shelf surface. Verify that control lever will clear vehicle components in all positions. Mark this location.
3. Remove the Dash Bracket. Place Dash Bracket in selected location and mark four (4) holes.
4. Check for adequate drill clearance. Drill 1/8" holes in marked locations. Secure Dash Bracket using No. 10 x 1" sheet metal screws and lock washers.
5. Place Control Bracket into Dash Bracket and fasten in desired position. Bend top flange of Control Bracket to desired position.

IIIa CONTROL INSTALLATION INSTRUCTION FOR EXTRA DUTY (CABLE OPERATED) ISARMATIC® MARK IIIa ARE ON PAGE 4

INSTALLATION INSTRUCTIONS FOR 59700 BLADE GUIDE ASSEMBLY

Insert pointed end of clamp into coil of Blade Guide Rod. Attach a Blade Guide Rod to each outer rib using 5/16" x 1" capscrews and locknuts as shown in diagram.

PARTS LIST 59700 — BLADE GUIDE ASSEMBLY

Item	Part No.	Quan.	Description
1	59697	2	BLADE GUIDE ROD, S-HOOK & FLAG
2	59694K	1	BLADE GUIDE FLAG
3	59696	1	S-HOOK
4	59691	1	BLADE GUIDE ROD
5	59946	2	CLAMP
6	90020	4	5/16-18X1 HX CS G2 ZP
7	91332	4	5/16-18 PT HX LK NUT NYIS ZP

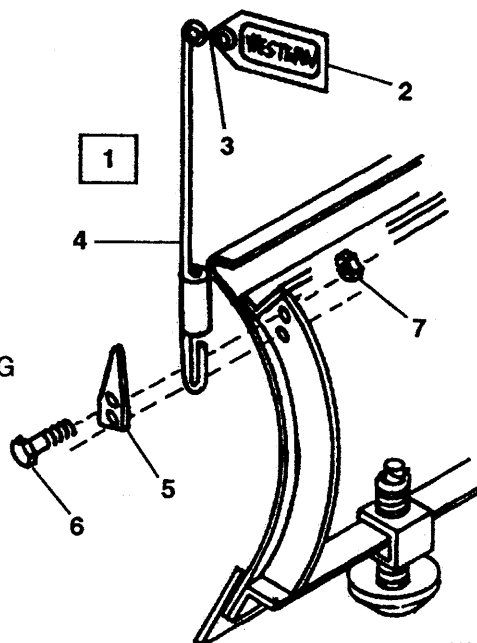

for IIIa CONTROL AND FLOOR BRACKET
CHEV/GMC "S" SERIES 4X4
MANUAL TRANSMISSION
1983 AND LATER

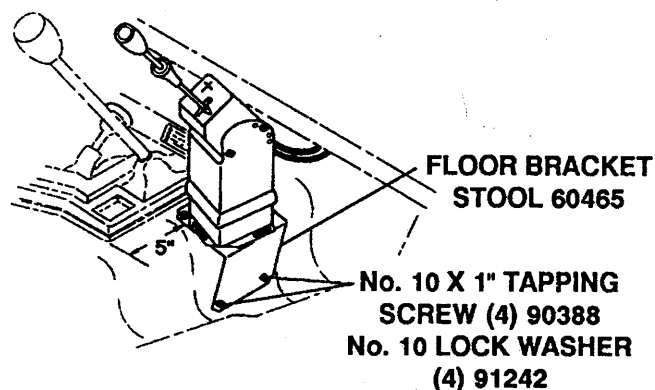

1. Position Floor Bracket Stool five (5) inches from edge of floor console as shown. Mark location of four (4) mounting holes. Check for adequate drill clearance before drilling two (2) 9/64" holes into top of tunnel and two into side of tunnel.
2. Assemble Floor Bracket Stool to Floor Bracket using three (3) No. 10 x 3/8" long hex head tapping screws. **DO NOT TIGHTEN SCREWS.** Slide Rubber Boot half way down on Floor Bracket.
3. Assemble IIIa Control to Floor Bracket using four (4) No. 8 x 5/8" long hex head screws.
4. Pass Control Cables through holes drilled in passenger side of firewall per hydraulic system instructions.
5. Place assembled control in position and secure with four (4) No. 10 x 1" sheet metal screws and lock washers.
6. Rotate Floor Bracket to desired position and tighten mounting screws. Slide Rubber Boot down to cover screws.

for IIIa CONTROL AND FLOOR BRACKET
CHEV/GMC "S" SERIES 4X4
AUTOMATIC TRANSMISSION
1983 AND LATER

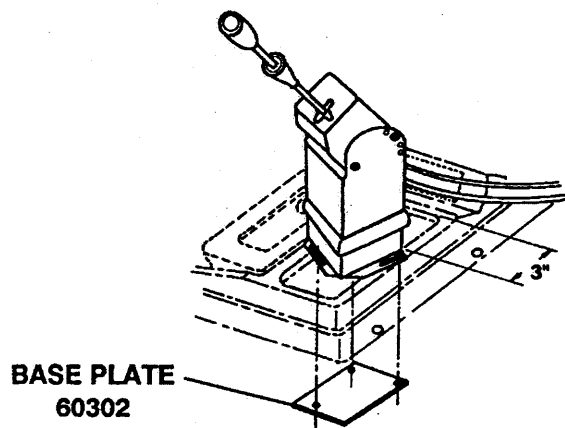

1. Use base plate as a template placing it on top of console per dimension shown. **NOTE:** The single offset hole is toward drivers side. Mark the three hole locations.
2. Remove console retaining screws and check for adequate drill clearance before drilling 3/16" holes in marked location.
3. Position Floor Bracket over drilled holes and start three (3) No 10 x 1" screws into base plate held under the console. (**DO NOT TIGHTEN FLANGE SCREWS**).
4. Reinstall console. Slide Rubber Boot half way down on Floor Bracket.
5. Pass Control Cables through holes drilled in passenger side of firewall per hydraulic system instructions. Assemble IIIa Control to Floor Bracket as shown with four (4) No.8 x 5/8" screws.
6. Rotate Floor Bracket to desired position and tighten mounting screws. Slide Rubber Boot down to cover screws.

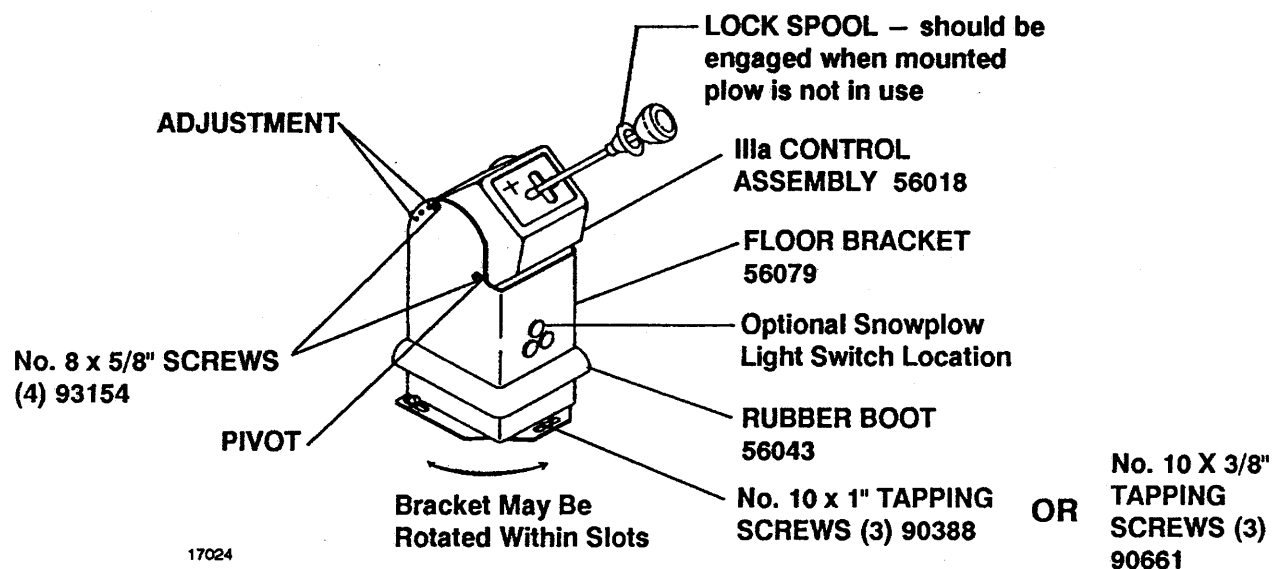

The following are registered® and unregistered™ Trade Marks of Douglas Dynamics, Inc.
WESTERN® ISARMATIC® Hydra-Turn® Roll-Action™ PRO-GUARD™

Western reserves the right under its Product Improvement Policy to change construction details and furnish equipment when so altered without reference to illustrations or specifications used herein.