



Western Products  
PO Box 245038  
Milwaukee, WI 53224-9538  
www.westernplows.com

**A DIVISION OF DOUGLAS DYNAMICS, LLC**

**77472 – WIDE-OUT™ &  
77473 – WIDE-OUT™ XL Blades**

## **WEAR STRIP KIT**

### **Installation Instructions**

## **INSTALLATION INSTRUCTIONS**

### **⚠ WARNING**

Do not exceed GVWR or GAWR, including blade and ballast. The rating label is found on the driver-side vehicle door cornerpost.

### **⚠ WARNING**

Blade can drop unexpectedly. Place quadrant on jack stands. Failure to do so could result in serious personal injury.

### **⚠ CAUTION**

Read this document before installing the wear strip kit.

### **⚠ CAUTION**

Use standard methods and practices when attaching snowplow and installing accessories, including proper personal protective safety equipment.

### **⚠ CAUTION**

See your WESTERN® outlet/website for specific vehicle application recommendations before installation. The Quick Match selection system has specific vehicle and snowplow requirements.

1. Park the vehicle on a smooth, level, hard surface, such as concrete. Raise the blade, then turn the control OFF. From the side of the blade assembly, place jack stands under the quadrant.
2. Turn the control ON and lower the blade so that the blade rests securely on the jack stands. Fully extend the blade wings to the straight position.
3. Turn the control OFF. Turn the vehicle ignition to the "OFF" position and remove the key.

4. Determine whether the blade has three pre-drilled holes along the top edge for installing the wear strips. *If the blade already has the three required holes, continue with Step 5. If it does not have all three required holes go to Step 6.*
5. **Blades with three existing holes:** Install a wear strip at each end of the moldboard using the supplied 3/8" x 1" hex socket head screws, 3/8" flat washers, and 3/8" brass locknuts. (The wear strips should slightly overhang the blade moldboard, as shown.) *Proceed to Step 7.*

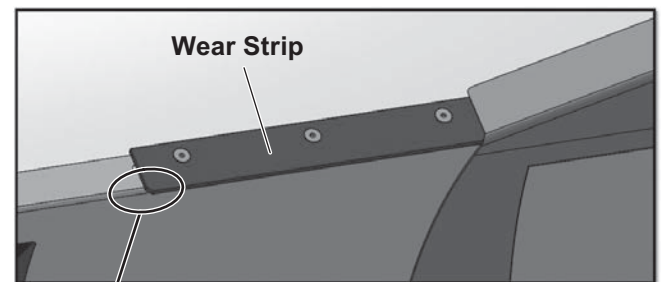
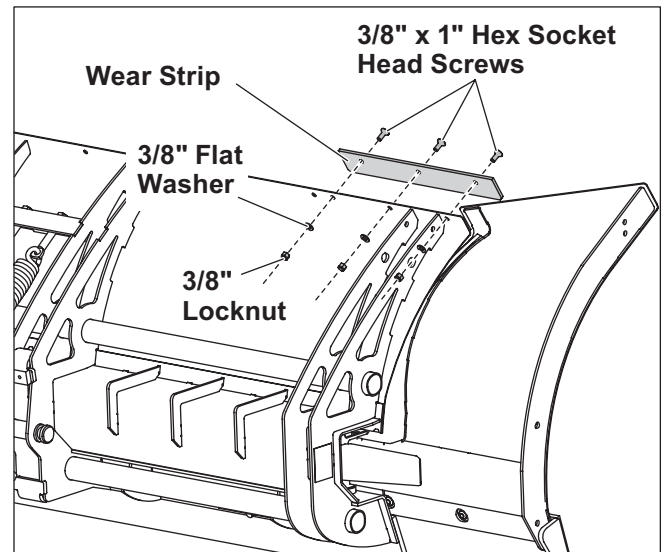

**Wear strip slightly overhangs edge of moldboard.**

## 77472, 77473 WEAR STRIP KIT

### 6. Blades without all three required holes:

- Cut out the templates on page 3 of these instructions.
- Align the *driver-side* template against the moldboard edges as shown.

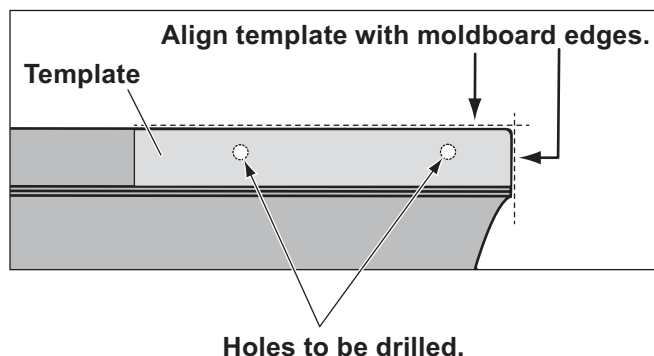

- Center punch the two hole locations indicated on the template. Remove the template and drill 7/16" holes at the marked points.
- Install the plastic wear strip using two 3/8" x 1" hex socket head screws, 3/8" flat washers, and 3/8" brass locknuts in the drilled holes. The wear strip will slightly overhang the blade moldboard, as shown in the Step 6e illustration.

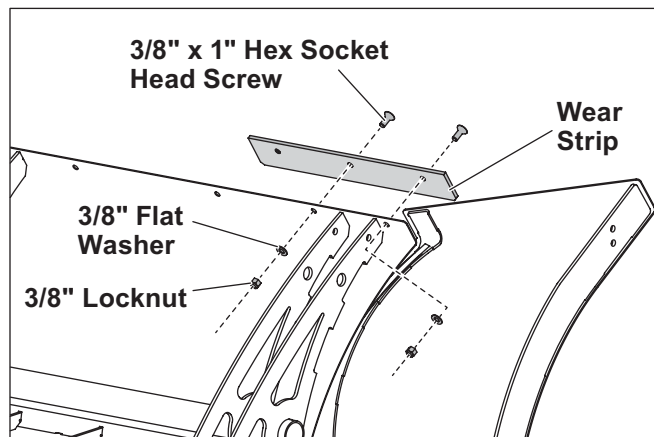

- Using the mounted wear strip as a guide, drill a third 7/16" hole through the moldboard and install the third set of fasteners.

### Drill hole for third set of fasteners.

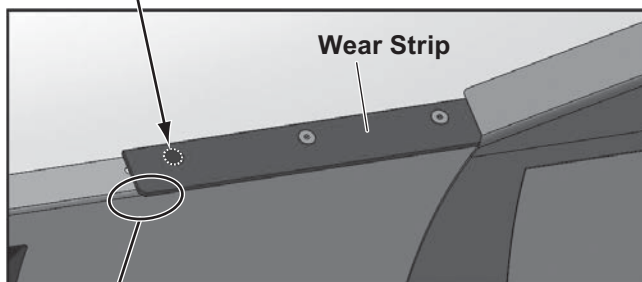

### Wear strip slightly overhangs edge of moldboard.

- Repeat Steps 6a–6e on the opposite end of the blade, using the *passenger-side* template to mark for drill holes.

- Fully tighten the wear strip fasteners to 31 ft-lb.

**WIDE-OUT and WIDE-OUT XL  
Driver-Side Wear Strip**

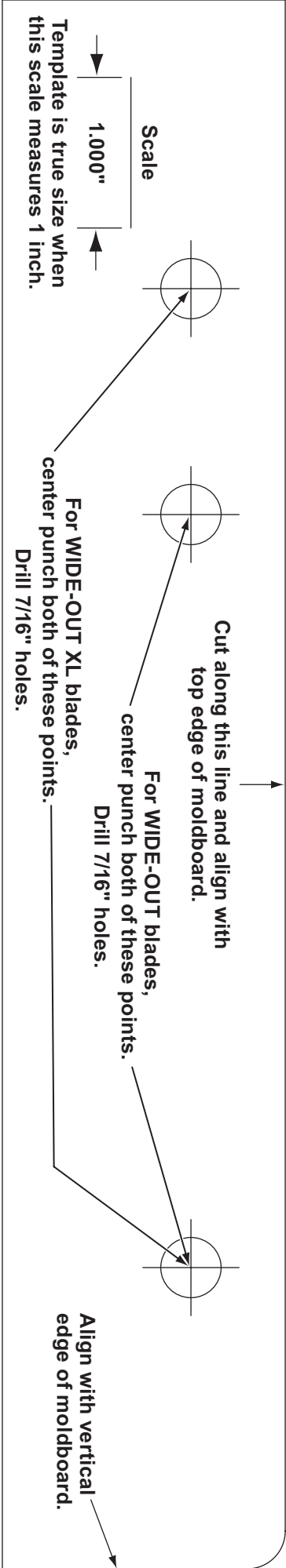

**WIDE-OUT™ and WIDE-OUT™ XL  
Passenger-Side Wear Strip**

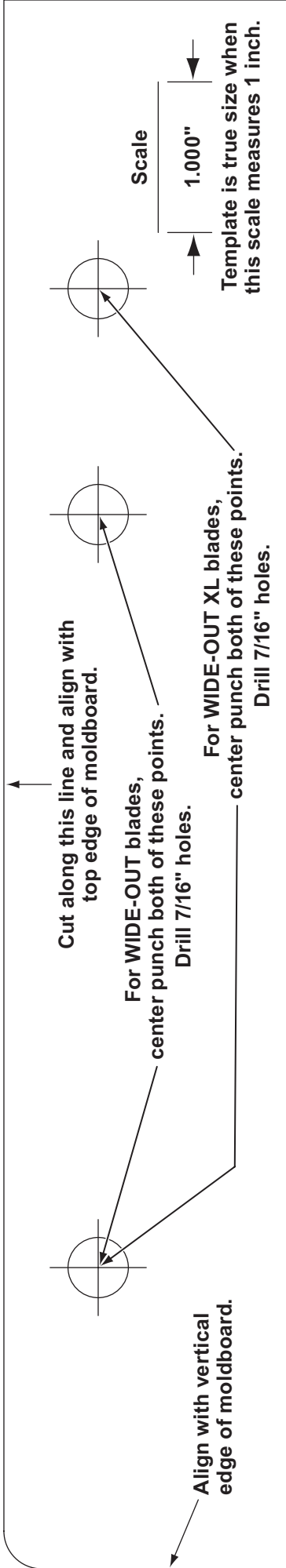

## 77472, 77473 WEAR STRIP KIT

---

Western Products reserves the right under its product improvement policy to change construction or design details and furnish equipment when so altered without reference to illustrations or specifications used. Western Products or the vehicle manufacturer may require or recommend optional equipment for snow removal. Do not exceed vehicle ratings with a snowplow. Western Products offers a limited warranty for all snowplows and accessories. See separately printed page for this important information. The following are registered (®) or unregistered (™) trademarks of Douglas Dynamics, LLC: UltraMount® 2, WESTERN®, WIDE-OUT™, WIDE-OUT™ XL.

**Printed in U.S.A.**

---