



Western Products  
PO Box 245038  
Milwaukee, WI 53224-9538  
www.westernplows.com

**A DIVISION OF DOUGLAS DYNAMICS, LLC**

**57409 & 57425 – PRO PLUS® HD  
10' BLADE**

**RUBBER DEFLECTOR KIT –  
10" & 18"**

**Parts List & Installation Instructions**

## PARTS LIST

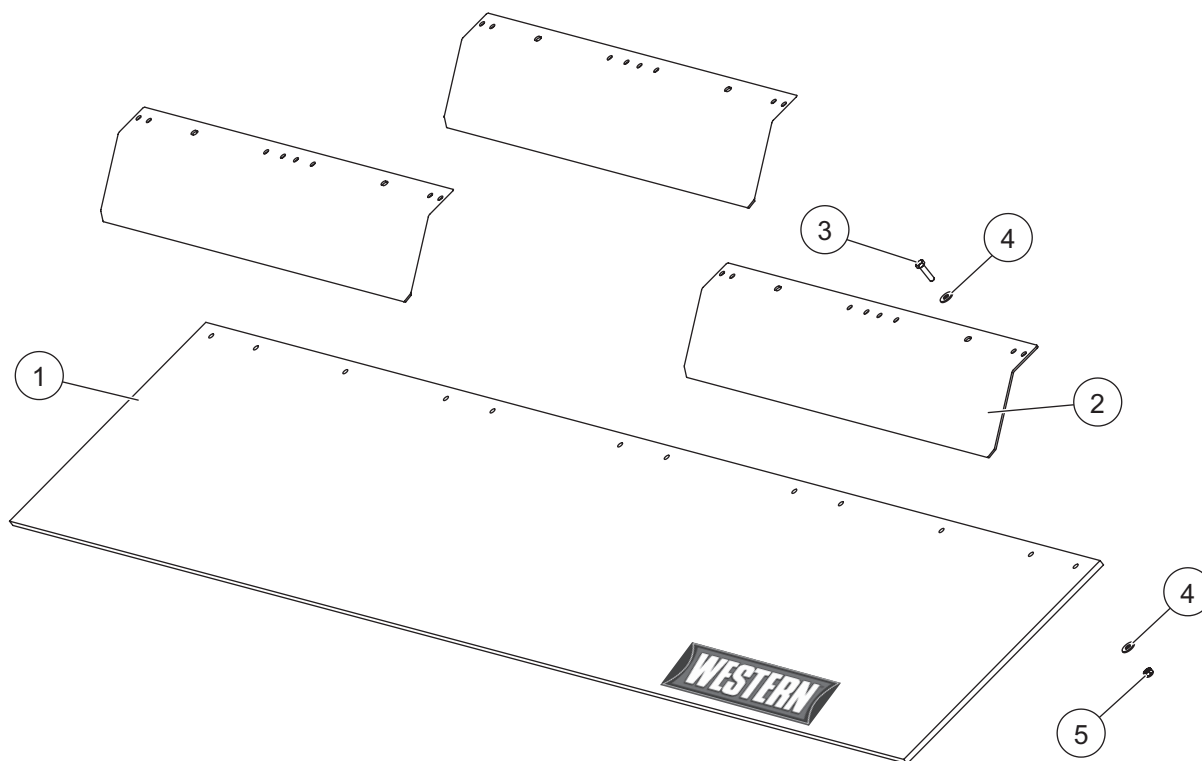

**18" Deflector Shown**

<b>57409 Rubber Deflector Kit – 18"</b>							
Item	Part	Qty	Description	Item	Part	Qty	Description
1	57383	1	Rubber Deflector, 3/8 x 18 x 120	ns	52540	1	Bolt Bag
2	57408	3	Deflector Bracket (18" only)				
<b>57425 Rubber Deflector Kit – 10"</b>							
ns	57416	1	Rubber Deflector, 3/8 x 10 x 120	ns	52540	1	Bolt Bag
ns	57410	3	Deflector Bracket (10" only)				
<b>52540 Bolt Bag</b>							
3		12	5/16-18 x 1-1/4 Hex Cap Screw G5	5		12	5/16 Hex Locknut GB
4		24	5/16 Flat Washer				
ns = not shown				G = Grade			

# 57409 & 57425 RUBBER DEFLECTOR KIT

## INSTALLATION INSTRUCTIONS

### **⚠ WARNING**

Do not exceed GVWR or GAWR, including blade and ballast. The rating label is found on the driver-side vehicle door cornerpost.

### **⚠ CAUTION**

Read this document before installing the rubber deflector kit.

### **⚠ CAUTION**

Use standard methods and practices when attaching snowplow and installing accessories, including proper personal protective safety equipment.

### **⚠ CAUTION**

See your WESTERN® outlet/website for specific vehicle application recommendations before installation. The Quick Match selection system has specific vehicle and snowplow requirements.

This deflector kit is designed to fit only the PRO PLUS® HD 10' blade.

**NOTE: Due to the weight and size of this deflector, two people are recommended for installation.**

1. Park the vehicle on a smooth, level, hard surface, such as concrete. Lower the blade to the ground, and turn the control OFF. Disconnect the snowplow from the vehicle, or turn the vehicle ignition to the "OFF" position and remove the key.
2. Starting with the outside deflector brackets and mounting holes and working towards the center, install the deflector using twelve 5/16" x 1-1/4" cap screws, twenty-four 5/16" flat washers, and twelve 5/16" locknuts.

Refer to the illustration below for fastener placement.

**NOTE: The deflector brackets will overlap. Do not shorten.**

3. Tighten all fasteners to 17 ft-lb.

**Deflector Bracket Bolt Pattern**

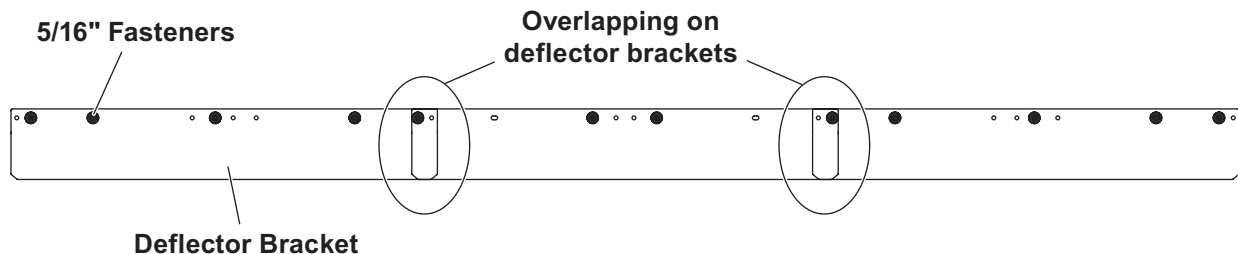

Copyright © 2018 Douglas Dynamics, LLC. All rights reserved. This material may not be reproduced or copied, in whole or in part, in any printed, mechanical, electronic, film, or other distribution and storage media, without the written consent of Western Products. Authorization to photocopy items for internal or personal use by Western Products outlets or snowplow owner is granted.

Western Products reserves the right under its product improvement policy to change construction or design details and furnish equipment when so altered without reference to illustrations or specifications used. Western Products or the vehicle manufacturer may require or recommend optional equipment for snow removal. Do not exceed vehicle ratings with a snowplow. Western Products offers a limited warranty for all snowplows and accessories. See separately printed page for this important information. The following are registered (®) or unregistered (™) trademarks of Douglas Dynamics, LLC: PRO PLUS®, UltraMount® 2, WESTERN®.

Printed in U.S.A.