



Western Products
PO Box 245038
Milwaukee, WI 53224-9538
www.westernplows.com

A DIVISION OF DOUGLAS DYNAMICS, LLC

80295 – Cutting Edge/Curb Guard Kit
86865 – Heavy-Duty Curb Guard/Cutting Edge Kit
Parts List & Installation Instructions

PARTS LIST

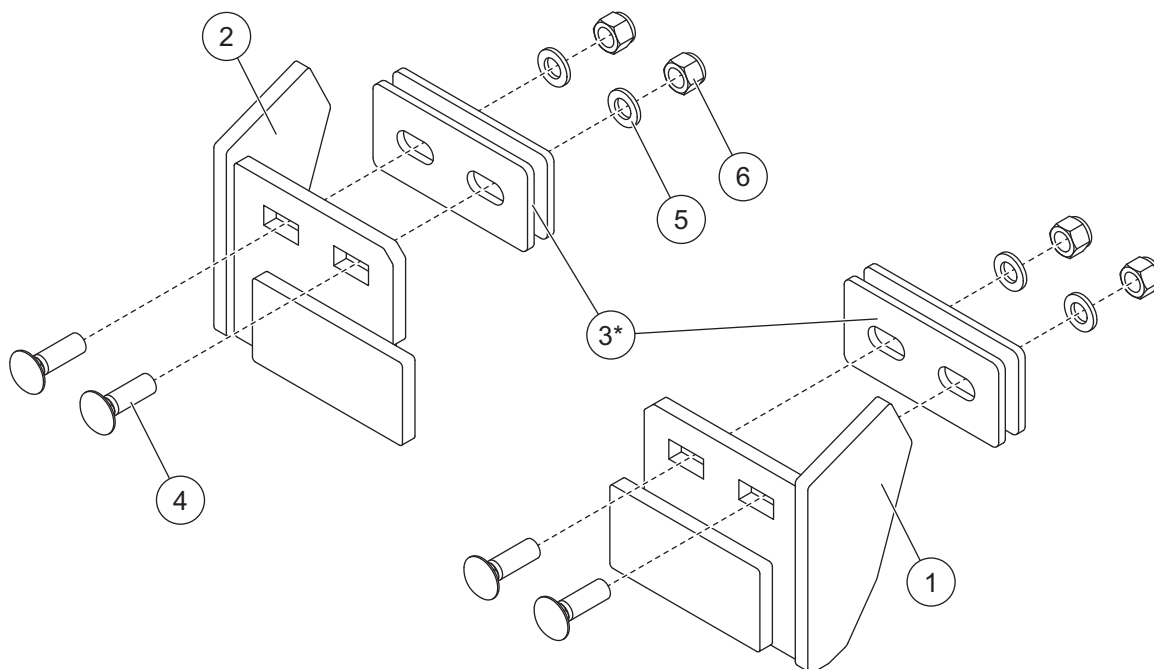

* Spacers included in heavy-duty kit only.

80295 Cutting Edge/Curb Guard Kit							
Item	Part	Qty	Description	Item	Part	Qty	Description
1	86663	1	Curb Guard, DS	ns	80298	1	Bolt Bag
2	86664	1	Curb Guard, PS				
80298 Bolt Bag							
4		4	5/8-11 x 2-1/2 Carriage Bolt G5	6		4	5/8-11 Hex Locknut GB
5		4	5/8 Hardened Flat Washer				
ns = not shown				G = Grade			

86865 Heavy-Duty Cutting Edge/Curb Guard Kit							
Item	Part	Qty	Description	Item	Part	Qty	Description
1	86663	1	Curb Guard, DS	3		6	Spacer
2	86664	1	Curb Guard, PS	ns	80298	1	Bolt Bag
80298 Bolt Bag							
4		4	5/8-11 x 2-1/2 Carriage Bolt G5	6		4	5/8-11 Hex Locknut GB
5		4	5/8 Hardened Flat Washer				
ns = not shown				G = Grade			

INSTALLATION INSTRUCTIONS

⚠ WARNING

Do not exceed GVWR or GAWR, including blade and ballast. The rating label is found on the driver-side vehicle door cornerpost.

⚠ WARNING

Blade can drop unexpectedly. Place blade on jack stands. Failure to do so could result in serious personal injury.

⚠ CAUTION

Read this document before installing the cutting edge/curb guard kit.

⚠ CAUTION

Use standard methods and practices when attaching snowplow and installing accessories, including proper personal protective safety equipment.

⚠ CAUTION

See your WESTERN® outlet/website for specific vehicle application recommendations before installation. The Quick Match selection system has specific vehicle and snowplow requirements.

1. Park the vehicle on a smooth, level, hard surface, such as concrete. Raise the blade, then turn the control OFF. From the side of the blade assembly, place jack stands under the blade.
2. Turn the control ON and lower the blade so that the blade rests securely on the jack stands. Turn the control OFF. Turn the vehicle ignition to the "OFF" position and remove the key.
3. Remove the two outermost carriage bolts from one end of the blade.
4. Install the curb guard to the blade using two 5/8" x 2-1/2" carriage bolts, two 5/8" washers, and two 5/8" locknuts. Hand tighten.

5/8" Edges: For all 5/8" edges, install one spacer between the curb guard and blade.

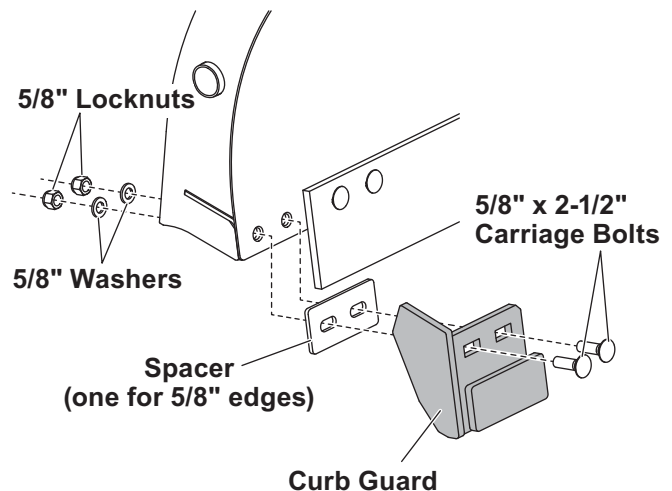

80295/86865 CUTTING EDGE/CURB GUARD KIT

Carbide Edges: For all carbide edges, install two spacers between the curb guard and blade.

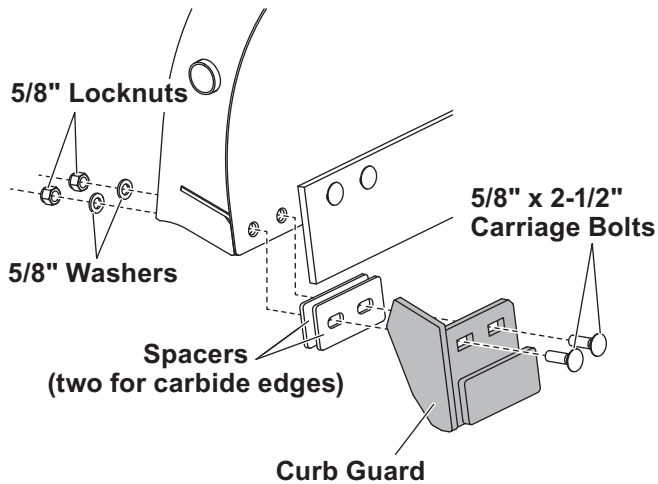

5. Repeat Steps 3 and 4 on the other end of the blade.

6. Fully tighten all cutting edge/curb guard fasteners to 150 ft-lb.

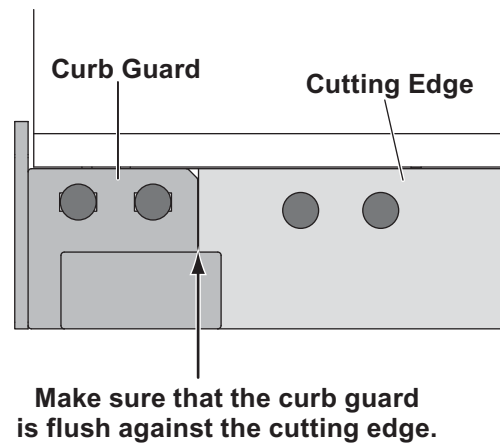

NOTE: Prior to tightening the fasteners, make sure that the curb guard is flush against the cutting edge.

7. Turn the vehicle ignition and snowplow control ON. Raise the blade slightly. Turn the control OFF and remove the jack stands.
8. Stand 8 feet clear of the blade, and lower the blade to the ground.
9. Level according to the snowplow Installation Instructions or Owner's Manual.

80295/86865 CUTTING EDGE/CURB GUARD KIT

Copyright © 2019 Douglas Dynamics, LLC. All rights reserved. This material may not be reproduced or copied, in whole or in part, in any printed, mechanical, electronic, film, or other distribution and storage media, without the written consent of Western Products. Authorization to photocopy items for internal or personal use by Western Products outlets or snowplow owner is granted.

Western Products reserves the right under its product improvement policy to change construction or design details and furnish equipment when so altered without reference to illustrations or specifications used. Western Products or the vehicle manufacturer may require or recommend optional equipment for snow removal. Do not exceed vehicle ratings with a snowplow. Western Products offers a limited warranty for all snowplows and accessories. See separately printed page for this important information. The following are registered (®) trademarks of Douglas Dynamics, LLC: UltraMount® 2, WESTERN®.

Printed in U.S.A.
