

PARTS LIST

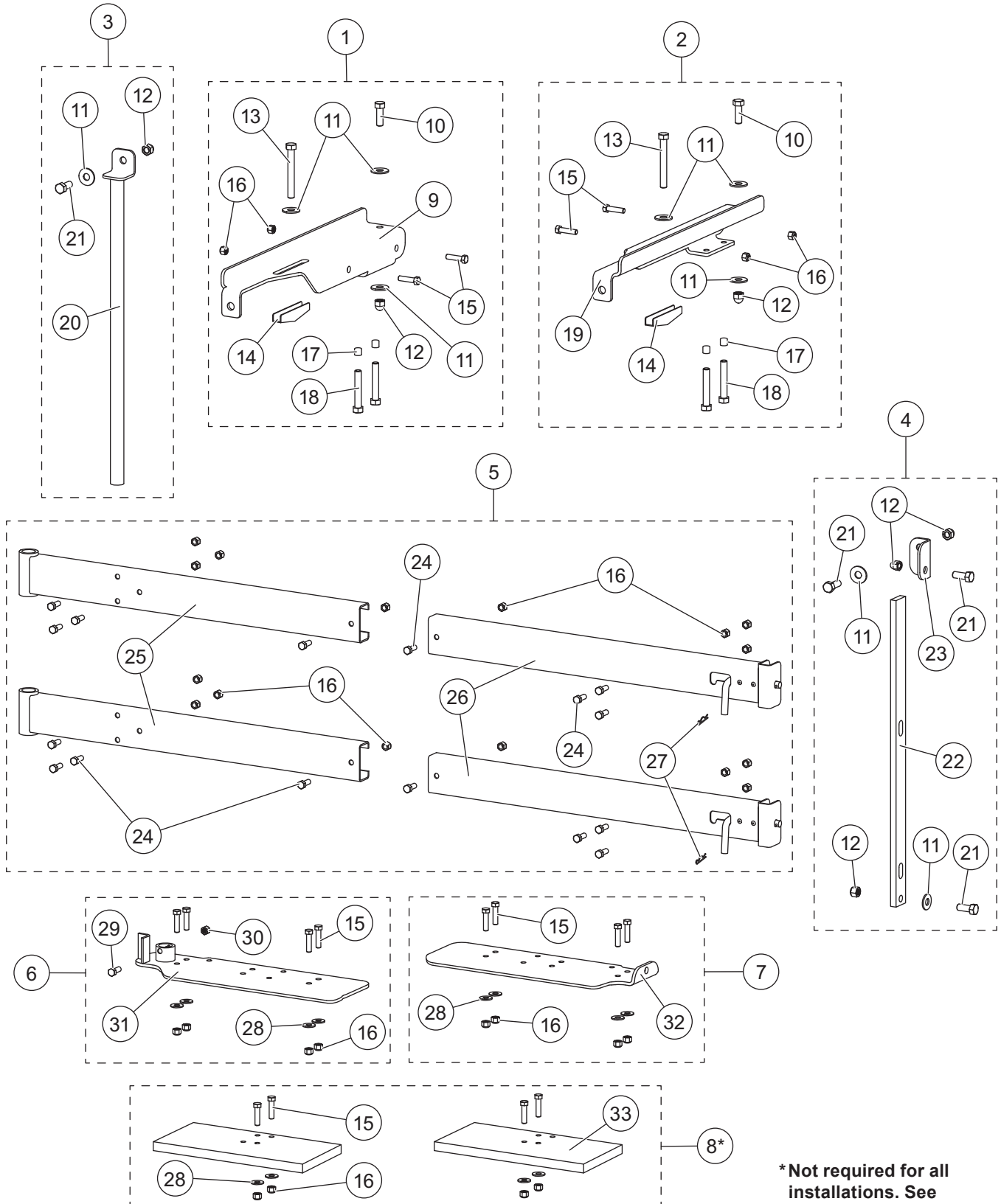

*Not required for all installations. See Installation Instructions.

75917 Pivot Mount							
Item	Part	Qty	Description	Item	Part	Qty	Description
1	74990	1	Bed Rail Bracket Kit – DS	5	74994	1	Mount Channel Kit
2	74987	1	Bed Rail Bracket Kit – PS	6	74996	1	Pivot Bumper Plate Mounting Kit
3	74986	1	Pivot Tube Kit	7	74997	1	Latch Bar Bumper Plate Mounting Kit
4	74995	1	Latch Bar Mounting Kit	8	74985*	1	GM Spacer Bumper Kit
Item 1 74990 Bed Rail Bracket Kit – DS							
9		1	Bed Rail Bracket – DS	14		1	1/2-13 Toggle Nut
10		1	1/2-13 x 1-1/2 Hex Cap Screw	15		2	3/8-16 x 1-1/2 Hex Cap Screw
11		3	1/2 Flat Washer	16		2	3/8-16 Locknut
12		1	1/2-13 Locknut	17		2	Rubber Tip Protector
13		1	1/2-13 x 4 Bolt, Tap	18		2	1/2-13 x 3 Hex Cap Screw, Full Thread
Item 2 74987 Bed Rail Bracket Kit – PS							
10		1	1/2-13 x 1-1/2 Hex Cap Screw	15		2	3/8-16 x 1-1/2 Hex Cap Screw
11		3	1/2 Flat Washer	16		2	3/8-16 Locknut
12		1	1/2-13 Locknut	17		2	Rubber Tip Protector
13		1	1/2-13 x 4 Bolt, Tap	18		2	1/2-13 x 3 Hex Cap Screw, Full Thread
14		1	1/2-13 Toggle Nut	19		1	Bed Rail Bracket – PS
Item 3 74986 Pivot Tube Kit							
11		1	1/2 Flat Washer	20		1	Pivot Tube Assembly
12		1	1/2-13 Locknut	21		1	1/2-13 x 1-1/4 Hex Cap Screw
Item 4 74995 Latch Bar Mounting Kit							
11		3	1/2 Flat Washer	22		1	Latch Bar
12		3	1/2-13 Locknut	23		1	Pivot Tube Mounting Bracket
21		3	1/2-13 x 1-1/4 Hex Cap Screw				
Item 5 74994 Mount Channel Kit							
16		16	3/8-16 Locknut	26		2	Latch Channel Assembly
24		16	3/8-16 x 1 Hex Cap Screw	27		2	1/8 x 2-1/16 Hairpin Cotter
25		2	Pivot Channel Assembly				
Item 6 74996 Pivot Bumper Plate Mounting Kit							
15		4	3/8-16 x 1-1/2 Hex Cap Screw	29		1	5/16-18 x 2 Hex Cap Screw
16		4	3/8-16 Locknut	30		1	5/16-18 Locknut
28		4	3/8 Flat Washer	31		1	Pivot Bumper Plate
Item 7 74997 Latch Bar Bumper Plate Mounting Kit							
15		4	3/8-16 x 1-1/2 Hex Cap Screw	28		4	3/8 Flat Washer
16		4	3/8-16 Locknut	32		1	Latch Bumper Plate
Item 8 74985 GM Spacer Bumper Kit*							
15		4	3/8-16 x 1-1/2 Hex Cap Screw	28		4	3/8 Flat Washer
16		4	3/8-16 Locknut	33		2	Spacer Block

* Not required for all installations. See Installation Instructions.

Copyright © 2020 Douglas Dynamics, LLC. All rights reserved. This material may not be reproduced or copied, in whole or in part, in any printed, mechanical, electronic, film, or other distribution and storage media, without the written consent of the company. Authorization to photocopy items for internal or personal use by the company's outlets or spreader owner is granted.

The company reserves the right under its product improvement policy to change construction or design details and furnish equipment when so altered without reference to illustrations or specifications used. This equipment manufacturer or the vehicle manufacturer may require or recommend optional equipment for spreaders. Do not exceed vehicle ratings with a spreader. The company offers a limited warranty for all spreaders and accessories. See separately printed page for this important information.

Printed in U.S.A.