

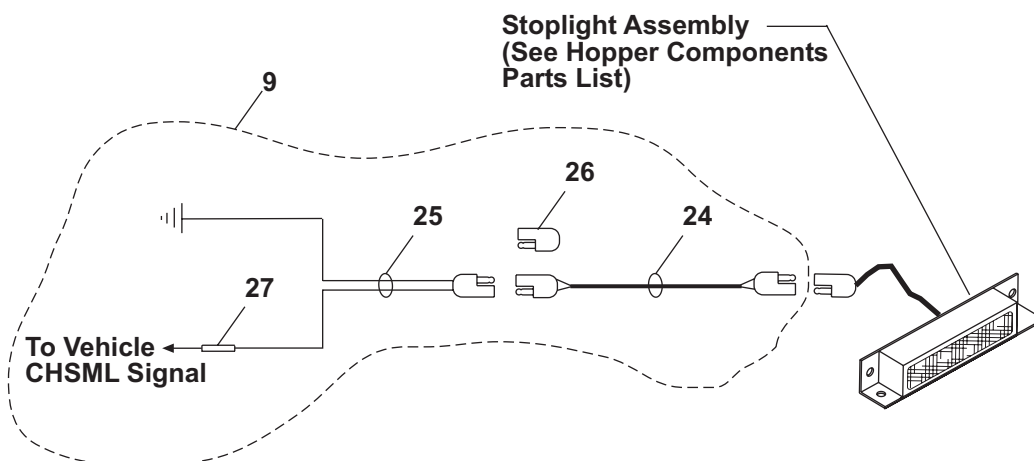

## 1000, 2000 and 110 Series Electrical Components Parts List

WESTERN PRODUCTS  
7777 North 73RD Street  
P.O. Box 23045  
Milwaukee, Wisconsin 53223

February 15, 1999  
Doc. No. 68688

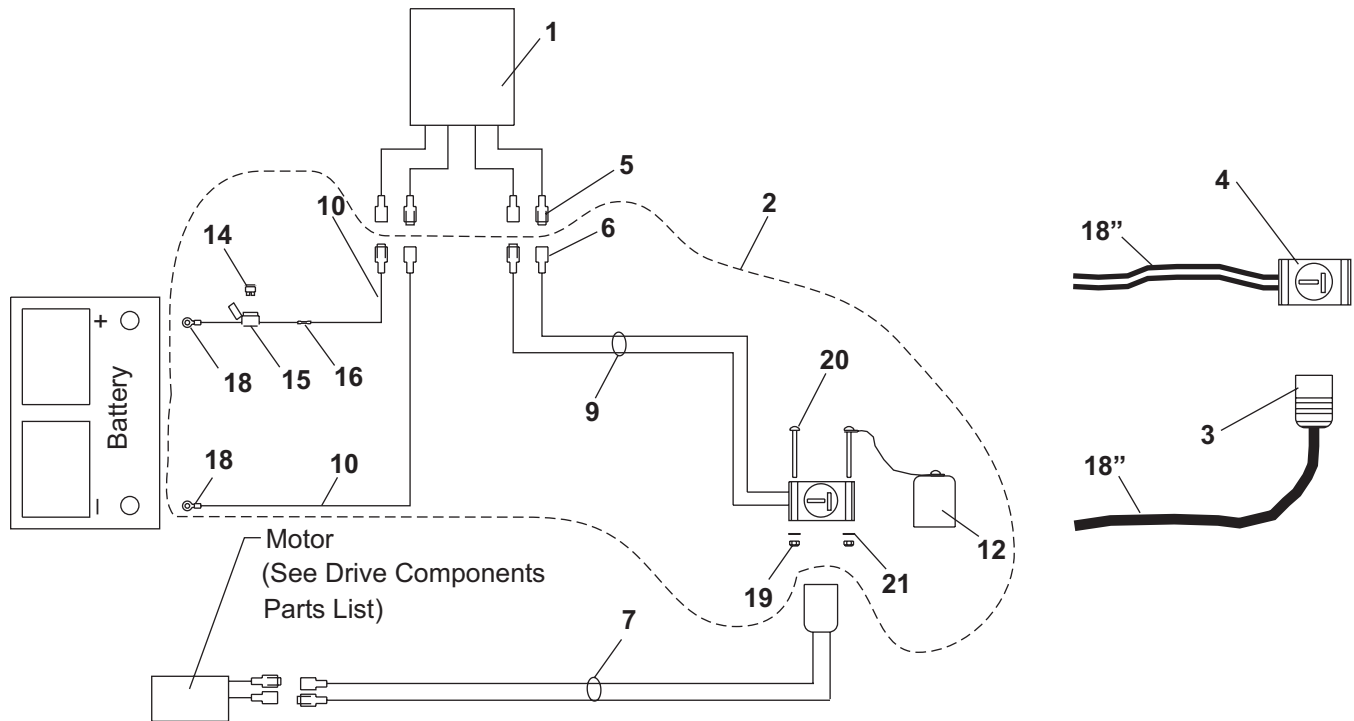

**NOTE:** Stoplight assembly is only included on 2000 series units. It may be purchased as an option for all other models.

- over -

## 1000, 2000 and 110 Series Electrical Components Parts List

1000, 2000 and 110 Series Electrical Components							
Item	Part	Qty	Description	Item	Part	Qty	Description
1	67437	1	Spreader Control On/Off	3	P2098	1	Male Patch Cord – 18" long
	67436		Spreader Control – Variable Speed	4	P2099	1	Female Patch Cord – 18" long
				5	M1458*	1	1/4" Blade Terminal
				6	M1459*	1	1/4" Insul. Receptacle
2	P3165	1	Control Wiring Kit (See list below)	7	P2156	1	Spreader Cord

1000, 2000 and 110 Series Control Wiring Kit - P3165							
Parts Included in P3165				Parts Included in P3166			
Item	Part	Qty	Description	Item	Part	Qty	Description
9	P2157	1	Control Harness 2 wire x 23 ft		61536	10	Cable Tie 14" (not shown)
10	P2158	1	Control Power Lead – Red	14	68658	1	Fuse 30 Amp Blade Style
11	P2159	1	Control Ground Lead – Black	15	68659	1	Fuse Holder – 10 Ga.
12	P2545	1	Plug Cap Assembly	16	68656	1	Butt Splice 10-12 Ga.
	P3166	1	Parts Bag (not shown)		66130	1	Rubber Grommet 3/8 ID (not shown)
			See next column	18	68646	2	5/16" Ring Terminal 10-12 Ga.
				19	M2007*	2	#10-32 Locknut
				20	68667*	2	#10-32 x 2 Machine Screw
				21	68668*	2	3/16" Plain Washer
					68669*	2	#10 x 1/2" Sheet Metal Screw
* available as a service parts kit only (5 pieces per package)							

2000 Series Stoplight Kit – 68794 (Not included on 1000 or 110 series units)							
Item	Part	Qty	Description	Item	Part	Qty	Description
24	68788	1	Stoplight Extension Cord	27	61592	1	Butt Splice
25	65363	1	Stoplight Vehicle Harness		59223	10	Cable Tie (not shown)
26	65364	1	Protective Plug		56099	1	Dielectric Grease Tube (not shown)

Copyright© 1999 Douglas Dynamics, L.L.C. All rights reserved. This material may not be reproduced or copied, in whole or in part, in any printed, mechanical, electronic, film or other distribution and storage media, without the written consent of Western Products. Authorization to photocopy items for internal or personal use by Western Products outlets is granted.

Western Products reserves the right under its product improvement policy to change construction or design details and furnish equipment when so altered without reference to illustrations or specifications used herein. Western Products and the vehicle manufacture may require and/or recommend optional equipment for snow and ice control. Western Products offers a limited warranty for all spreaders and accessories. See separately printed page for this important information. The following are registered trademarks of Douglas Dynamics, L.L.C.: WESTERN®.