



**WESTERN PRODUCTS**  
7777 NORTH 73RD STREET  
P.O. BOX 23045  
MILWAUKEE, WISCONSIN 53223

Harness/Bracket Kit  
**4 WIRE — 2 HARNESS**  
Use with 60740  
Headlamp Kit — 4 Wire  
**WIRING DIAGRAM**

# WITH PLUG-IN LIGHT HARNESS

## DO NOT CUT INTO VEHICLE HEADLAMP WIRING

CHECK YOUR LOCAL  
REGULATIONS FOR  
COMPLIANCE IN  
YOUR AREA.

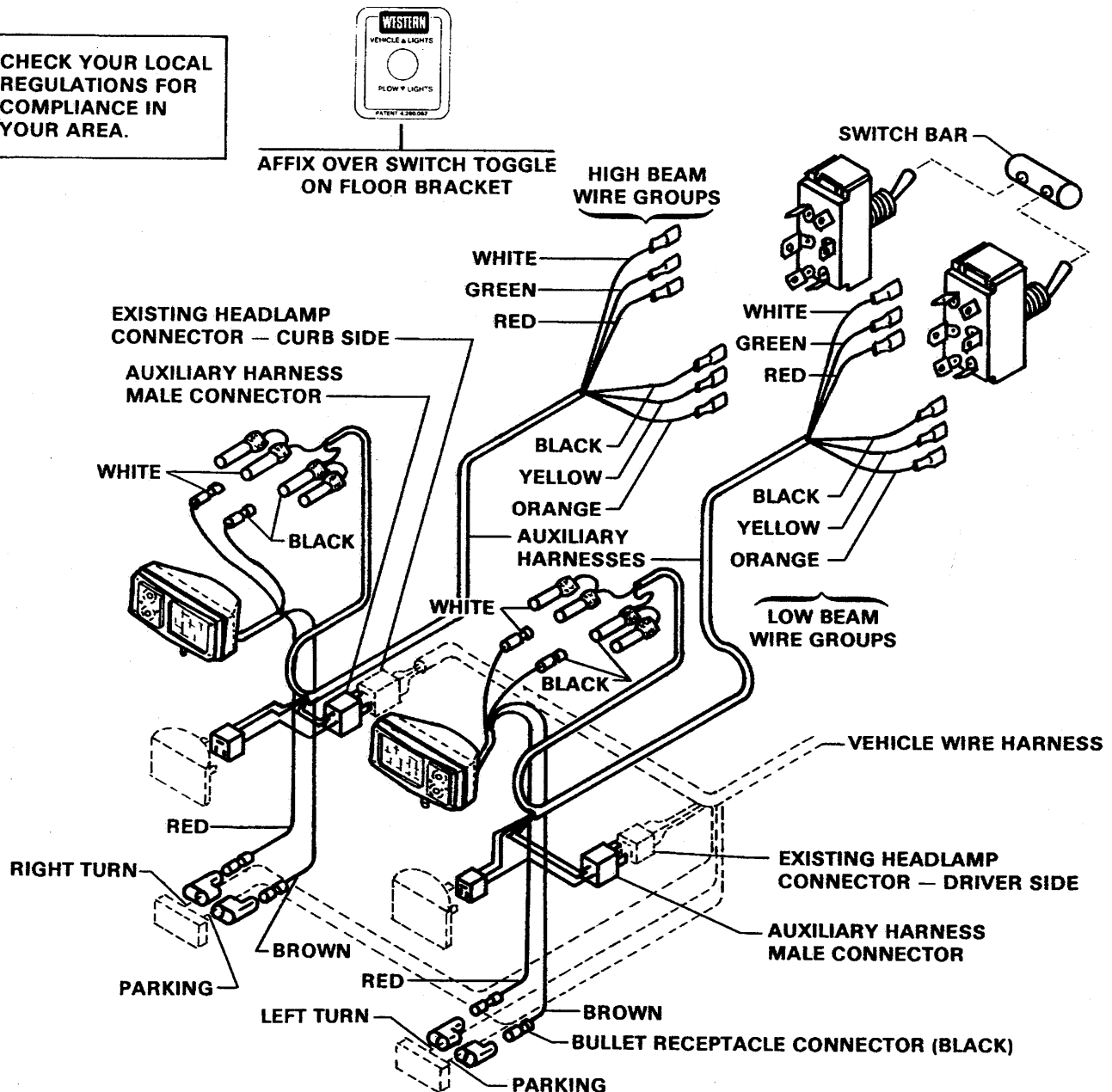

**4 WIRE — 2 HARNESS**

Use with 60740

Headlamp Kit — 4 Wire

**INSTALLATION INSTRUCTIONS**

This Harness/Bracket Kit, when used with a 60740 Headlamp Kit, includes two (2) plug-in wiring harnesses, connectors and two (2) switches to simplify installation and provide performance equal to existing vehicle system. Always check to be certain the vehicle lights work properly before beginning the installation.

1. Assemble light brackets to lift frame as shown on parts diagram.
2. Assemble headlamps to brackets with headlamp swivel above brackets and loosely secured with lock washer and nut. Pass leads thru grille. Secure leads to brackets with cable ties.
3. Identify park and turn lamp wires on both sides of vehicle.

**CAUTION:** Before proceeding, disconnect battery ground cable to avoid possible electrical equipment damage, electrical fire or personal injury.

Attach a black self stripping bullet receptacle connector to each wire. Route auxiliary headlamp red and brown wires to receptacles. Insert **RED** wire bullets into **TURN** wire receptacles and **BROWN** wire bullets into **PARK** wire receptacles.

4. See Lift-Mount Installation Instructions for location of Floor Bracket and switches. Drill two (2) 1/2" holes thru the firewall near switch location. CHECK for adequate clearance before drilling.
5. SEE PAGE 4 OF THESE INSTRUCTIONS TO MODIFY BOTH PLUG-IN HARNESSES BEFORE INSTALLATION.
6. Driver's Side — Install one Plug-In Harness (60584 harness if 2B/2D installation or one 60586 harness if 9004 (HB1) installation) by inserting end of harness with 6 loose wires thru a firewall hole drilled in Step 4. Route harness to vehicle headlamp.
7. Curb Side — Install second Plug-In Harness (59805 harness if 2B/2D installation or 60586 harness if 9004 (HB1) installation) following same installation procedure as Step 6.
8. BOTH SIDES OF VEHICLE: Remove existing connectors from headlamps (NOTE: Vehicle headlamp connectors with lock feature — squeeze both sides of rubber boot to remove headlamp connectors) and couple to auxiliary harness male connectors. Couple auxiliary harness headlamp connectors to headlamps.
9. EACH SIDE OF VEHICLE: Bring auxiliary harness and auxiliary headlamp black and white wire connectors to a common location behind the grille. MATCHING wire colors, black to black and white to white, insert headlamp wire bullets into harness receptacles.
10. Connect the six loose wire terminals of EACH auxiliary harness to a switch as shown in wiring diagram, Page 1. Slide Rubber Boot past switch holes in Floor Bracket. Install switches in a vertical position. Affix Dual Switch Label over switches. Slide Switch Bar over toggles of both switches.
11. Cut grommets, place one around each harness and insert into firewall holes drilled in Step 4. **CAUTION:** Always protect wires to prevent electrical short circuits or fires.

DO NOT REPLACE DIRECTIONAL LIGHT FLASHER unless noted in Lift-Mount Installation Instructions.

**FINAL CHECK:** When electrical circuits are completed, reconnect the vehicle battery. Check the operation of all vehicle lights. The vehicle and auxiliary headlamps are controlled by the selector switch. The park/turn lamps operate with vehicle lights. **Place selector switch in PLOW position and with plow in RAISED position, aim auxiliary headlamps** in accordance with SAE J599 Lighting Inspection Code (see Service Bulletin SP 608) and any federal, state, or local regulations that apply.

Finally, secure harnesses and wires with cable ties so they do not interfere with hot or moving parts in engine compartment.

**NOTE:** Auxiliary and vehicle headlamps will use headlamp fuses as designed by vehicle manufacturer (If one fuse is blown, neither vehicle or auxiliary headlamp on that side will light).

**CAUTION:** Auxiliary lights provide added safety and are a NHTSA requirement. **BEFORE TRAVELING POSITION BLADE SO IT DOES NOT BLOCK HEADLAMP BEAM. DO NOT CHANGE BLADE POSITION WHILE TRAVELING.**

Complete IIIa Control installation.

# Harness/Bracket Kit

## 4 WIRE — 2 HARNESS

Use with 60740

Headlamp Kit — 4 Wire

## DIAGRAM & PARTS LIST

1 NOT SHOWN

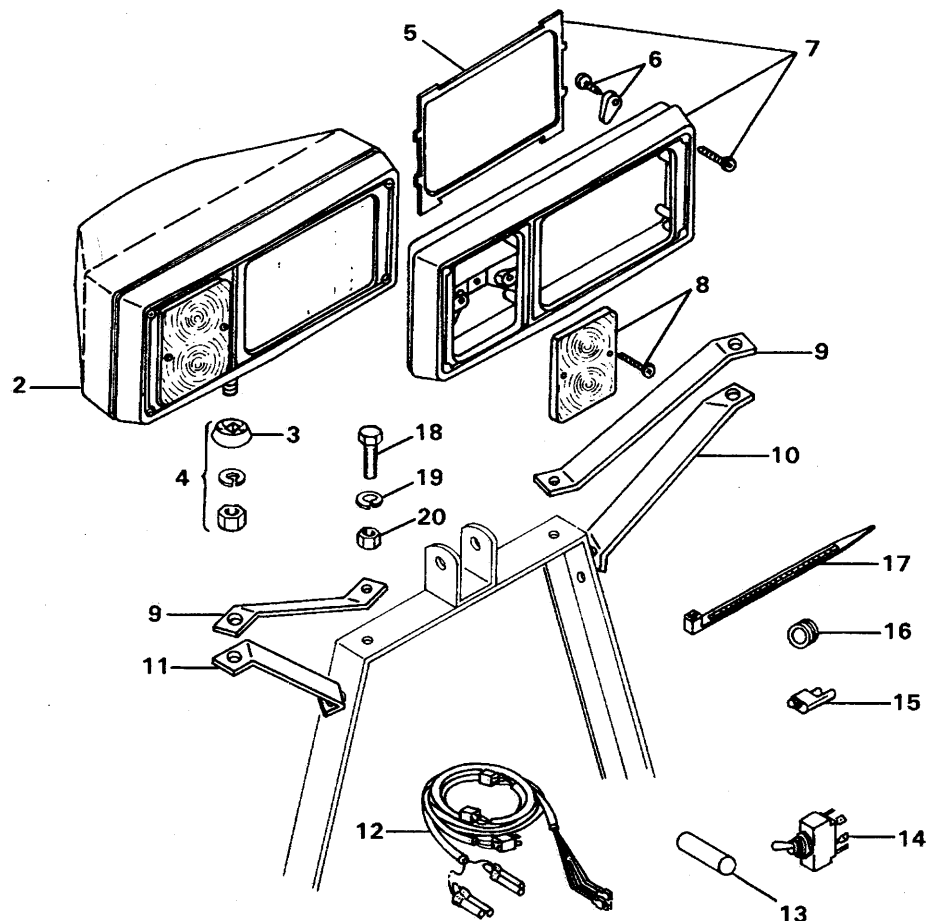

Item	Part No.	Quantity	Description
1	60741	1	Headlamp Assembly — 4 Wire — Driver Side
2	60742	1	Headlamp Assembly — 4 Wire — Curb Side
3	49012	2	Headlamp Swivel
4	49151	2	Headlamp Swivel and Hardware Assembly
5	49210	1	Headlamp Gaskets (1 Pair)
6	49201	2	2E Retaining Fingers (4) and Fasteners (4)
7	49203	2	Bezel, Headlamp Gasket and Fasteners (4) (Driver or Curb Side)
8	49202	2	Park/Turn Lens and Fasteners (2)
<b>NOTE:</b> Refer to Lift-Mount Box Parts List for any Special Bracket Requirements.			
9	59349	2	Light Bracket Bar
10	60005	1	Light Bracket Brace Bar — Driver Side
11	60006	1	Light Bracket Brace Bar — Curb Side
<b>NOTE:</b> Match Harness to Vehicle Headlamp Type.			
12	59805	1	Plug-In Harness 2B/2D
	60584	1	Plug-In Harness 2B/2D LG
	60586	2	Plug-In Harness 9004 HB1
13	60611	1	Switch Bar
14	53845	2	Switch
15	59224	4	Bullet Receptacle Connector
16	25301	2	Grommet
17	59223	6	Cable Tie
18		4	Capscrew — 3/8"-16 x 1-1/4" Long
19		4	Lock Washer — 3/8"
20		4	Hex Nut — 3/8"-16
<b>NOT SHOWN</b>			
	60612	1	Dual Switch Label
		2	Headlamp — 2E1 — Plastic
		4	Park/Turn Signal Bulb — (Trade Number 1157)
<b>NOTE:</b> Only those items listed with a <b>PART NUMBER</b> are available for service.			

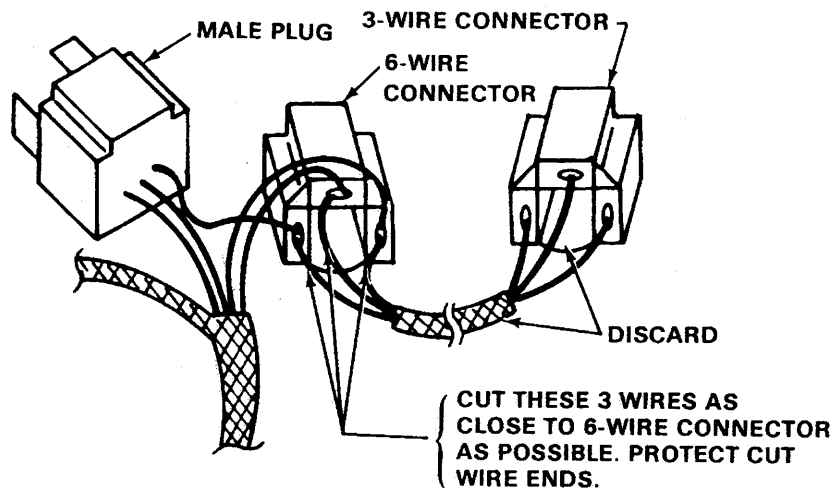

**MODIFY WIRING HARNESSES AS FOLLOWS:** Locate the headlamp connector with 6-wires. As close to 6-wire connector as possible, cut the 3 wires that go to the 3-wire connector (See Diagram). Protect ends of cut wires. (The 3-wire connector is not used on this installation. Modify both harnesses.)

The following are registered® or unregistered™ Trade Marks of Douglas Dynamics, Inc.  
 WESTERN® ISARMATIC® Hydra-Turn® Roll-Action™

Western reserves the right under its Product Improvement Policy to change construction or design details and furnish equipment when so altered without reference to illustrations or specifications used herein.